

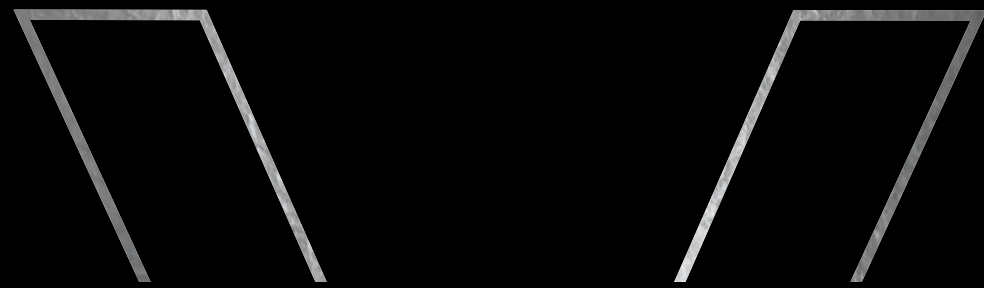

**RUSHIL**  
DECOR LIMITED  
WE'LL MAKE IT



EXTERIOR  
CLADDING



**VIR**  
KLADS



# EXTERIOR CLADDING

EXOTIC DESIGNS | WOOD GRAINS | SOLID PLAIN COLOR

## Core: Brown Core

Black core can be provided on demand

## Thickness available :

Min 6.0 mm to 15.0 mm  
(Customize thickness upon demand only)

## Size available :

2440 mm x 1220 mm (8 ft x 4 ft)  
3050 mm x 1300 mm (10 ft x 4.25 ft)

## Decorative Design Offerings

2440 mm x 1220 mm (8 ft x 4 ft)	
Weight of the panel @ 1.45 gm/m <sup>3</sup> .	
Thickness (mm)	Weight (Kg)
6.0	26
8.0	34.5
10.0	43
12.0	52

3050 mm x 1300 mm (10 ft x 4.25 ft)	
Weight of the panel @ 1.45 gm/m <sup>3</sup> .	
Thickness (mm)	Weight (Kg)
6.0	26
8.0	34.5
10.0	43
12.0	52



### Application of Exterior grade panel

- Wall Cladding
- Partition Walls
- Railings
- Front Gates and Doors
- Balconies
- Commercial Construction
- Ceilings / Roofing
- Out Door Table
- Outdoor Park Benches
- Out Door Furniture





# Certification

Vir Exterior Grade  
Compact Panel Certificates &  
Awards Recognition.

USFDA DUNS No. 864393171

**SIGMA** TEST & RESEARCH CENTRE  
TESTING OF FOOD | WATER | CHEMICALS | PETROLEUM PRODUCTS | BUILDING MATERIAL | ENVIRONMENT

BA-15, Mangolpuri Industrial area,  
Phase - 2, Delhi 110034(India)  
Ph: +91 11 49491400, 27022900  
Fax: +91 11 43852040  
E-mail: info@sigmatest.org  
web: www.sigmatest.org

**TEST CERTIFICATE**  
(This certificate is not valid without a hologram)

Report No-4001291 Report Date-14/06/2017  
Page 2 of 3

**Test conditions**  
Operating Cycle : 4 hours UV lights at 60±3°C followed by  
4 hours water condensation at 50±3°C without UV light.  
Light Source : Fluorescent UVB-313  
Irradiance : 0.71 W/m<sup>2</sup>  
Test Duration : 1500 Hours

**EVALUATION AND EXPRESSION OF RESULTS**  
1. CONTRAST  
Examine the contrast between the exposed and unexposed test specimens and record it in terms of a grade on the grey scale as defined in EN 20105-A02.  
2. APPEARANCE  
Examine the surface of test specimens with the naked eyes, corrected if necessary, at a distance of approximately 50 cm, assessing the appearance in comparison with the control specimen in accordance with following rating scale:  
Rating 5 : No visible change.  
Rating 4 : Change of gloss only.  
Rating 3 : Hairline surface cracks and/or delamination.  
Rating 2 : Surface cracks  
Rating 1 : Blistering and/or delamination.  
The light fastness of the test specimen is expressed in terms of the contrast being greater than, equal to or less than grade 4 of the grey scale.

**OBSERVATIONS:**

Check item	Test Result	Requirements	
Grey scale	Greater than 4	3 Min.	
Colour difference (ΔE)	1.57	-	
Colour coordinates	L	Before testing	50.31
		After testing	51.82
	a	Before testing	4.49
		After testing	4.47
	b	Before testing	17.36
		After testing	17.69
1. Crack and deformation	No crack and deformation observed after the test	-	
2. Rating	4	4 Min.	

Remark: The sample conforms to weather resistance requirements for resistance to UV light test as per EN 438-2:2016

Authorized Signatory  
SARAJI RAJPUT  
Technical Manager

WWW.SIGMAEST.ORG

(1) The results listed refer only to tested samples and applicable parameters. Endorsement of product is neither inferred nor implied. (2) Total liability of our Lab is limited to the reported amount. (3) Samples are retained for 7 days (in case of semi-perishable items) and 30 days for non-perishable samples or unless otherwise specified. (4) This Test Report is not to be reproduced wholly or in part and cannot be used as an evidence in the court of Law and should not be used in any advertising media without our special permission in writing. (5) The Test Report refer to the sample submitted to us and not drawn by Sigma Test & Research Centre unless mentioned otherwise.

AN ISO 9001:2015 & 14001:2015 ACCREDITED LABORATORY

USFDA DUNS No. 864393171

**SIGMA** TEST & RESEARCH CENTRE  
TESTING OF FOOD | WATER | CHEMICALS | PETROLEUM PRODUCTS | BUILDING MATERIAL | ENVIRONMENT

BA-15, Mangolpuri Industrial area,  
Phase - 2, Delhi 110034(India)  
Ph: +91 11 49491400, 27022900  
Fax: +91 11 43852040  
E-mail: info@sigmatest.org  
web: www.sigmatest.org

**TEST CERTIFICATE**  
(This certificate is not valid without a hologram)

Report No-4001291 Report Date-14/06/2017  
Page 2 of 3

**Test conditions**  
Irradiance : 340 nm (0.5 ±0.03 W/m<sup>2</sup>)  
Relative Humidity : 50%  
Black standard temp. : 65±3°C  
Test Duration : 1500 hours

**EVALUATION AND EXPRESSION OF RESULTS**  
1. CONTRAST  
Examine the contrast between the exposed and unexposed test specimens and record it in terms of a grade on the grey scale as defined in EN 20105-A02.  
2. APPEARANCE  
Examine the surface of test specimens with the naked eyes, corrected if necessary, at a distance of approximately 50 cm, assessing the appearance in comparison with the control specimen in accordance with following rating scale:  
Rating 5 : No visible change.  
Rating 4 : Change of gloss only.  
Rating 3 : Hairline surface cracks and/or delamination.  
Rating 2 : Surface cracks  
Rating 1 : Blistering and/or delamination.  
The light fastness of the test specimen is expressed in terms of the contrast being greater than, equal to or less than grade 4 of the grey scale.

**OBSERVATIONS:**

Check item	Test Result	Requirements	
Grey scale	Greater than 4	3 Min.	
Colour difference (ΔE)	1.63	-	
Colour coordinates	L	Before testing	50.41
		After testing	51.92
	a	Before testing	5.20
		After testing	5.72
	b	Before testing	19.26
		After testing	19.63
1. Crack and deformation	No crack and deformation observed after the test	-	
2. Rating	4	4 Min.	

Remark: The sample conforms to weather resistance requirement for resistance to artificial weathering test as per EN 438-2:2016.

Authorized Signatory  
SARAJI RAJPUT  
Technical Manager

WWW.SIGMAEST.ORG

(1) The results listed refer only to tested samples and applicable parameters. Endorsement of product is neither inferred nor implied. (2) Total liability of our Lab is limited to the reported amount. (3) Samples are retained for 7 days (in case of semi-perishable items) and 30 days for non-perishable samples or unless otherwise specified. (4) This Test Report is not to be reproduced wholly or in part and cannot be used as an evidence in the court of Law and should not be used in any advertising media without our special permission in writing. (5) The Test Report refer to the sample submitted to us and not drawn by Sigma Test & Research Centre unless mentioned otherwise.

AN ISO 9001:2015 & 14001:2015 ACCREDITED LABORATORY

USFDA DUNS No. 864393171

**SIGMA** TEST & RESEARCH CENTRE  
TESTING OF FOOD | WATER | CHEMICALS | PETROLEUM PRODUCTS | BUILDING MATERIAL | ENVIRONMENT

BA-15, Mangolpuri Industrial area,  
Phase - 2, Delhi 110034(India)  
Ph: +91 11 49491400, 27022900  
Fax: +91 11 43852040  
E-mail: info@sigmatest.org  
web: www.sigmatest.org

**TEST CERTIFICATE**  
(This certificate is not valid without a hologram)

Sample: VIR Exterior Grade Compact Panel  
(2440x1220x6mm)

Ref. No: N1  
Issued To: Raahil Decor Ltd  
Plot No-608, G.I.I.C.,  
At & Post, Marasa,  
District: Gandhinagar,  
Gujarat-382845

Report No-4001290  
Report Date: 14/06/2017  
Job Code STRC/4001290  
Sample Received On: 08/04/2017  
Date of Testing: 08/05/2017-14/06/2017  
Sample Qty.: 1 full board  
Page 1 of 3

BRAND NAME "VIR EXTERIOR GRADE COMPACT PANEL" GRADE - EDF\_HJPL/pr EN 438-6/EDF-N

Test: Resistance to climate shock  
Test Method = EN 438 - 2 - 2016  
Requirement = EN 438 - 6 - 2016  
Test Specimen = 120mm x 15mm x 6mm  
Date of Testing = 08/05/2017

S. No.	Test	Result	Requirement	Conforms	
1.	Flexural Strength Index	Avg	0.93	0.80 Min	Yes
		Min	0.86		
2.	Flexural Modulus Index	Avg	0.93	0.80 Min	Yes
		Min	0.84		
3.	Appearance rating	5	4 Min.	Yes	

Authorized Signatory  
RAJAN KUMAR CHOUDHARY  
Section Incharge

WWW.SIGMAEST.ORG

(1) The results listed refer only to tested samples and applicable parameters. Endorsement of product is neither inferred nor implied. (2) Total liability of our Lab is limited to the reported amount. (3) Samples are retained for 7 days (in case of semi-perishable items) and 30 days for non-perishable samples or unless otherwise specified. (4) This Test Report is not to be reproduced wholly or in part and cannot be used as an evidence in the court of Law and should not be used in any advertising media without our special permission in writing. (5) The Test Report refer to the sample submitted to us and not drawn by Sigma Test & Research Centre unless mentioned otherwise.

AN ISO 9001:2015 & 14001:2015 ACCREDITED LABORATORY

\*European std can be provided on demand by Manufacturer.

OR  
CLADDING

Test Report No. 7191166866-MEC17/4-YWA  
dated 21 Sep 2017

Note: This report is issued subject to the Testing and Certification Regulations of the TÜV SÜD Group and the General Terms and Conditions of Business of TÜV SÜD PSB Pte Ltd. In addition, this report is governed by its terms set out within this report.



**SUBJECT:**

Large scale surface spread of flame test on Brand: "VIR", Model: "Type-EDF/EDS/EGF/EGS" High-pressure decorative laminates (HPL) Exterior grade compact panel material submitted by Rushil Decor Limited on 23 Aug 2017.

**TESTED FOR:**

Rushil Decor Limited  
Near Nilkanth Green Villa  
Off. Sindhu Bhavan Road  
Shilaj, Ahmedabad  
380058 Gujarat  
India

**DATE OF TEST:**

30 Aug 2017

**PURPOSE OF TEST:**

To determine the tendency of the surface of a material or a combination of materials to support the spread of flame across its surface and to classify the surface according to the test given in British Standard 476 - Part 7 : 1997.

The test was conducted at TÜV SÜD PSB's fire test laboratory located at No. 10 Tuas Avenue 10, Singapore 639134.

Phone : +65-6885 1333  
Fax : +65-6778 8670  
Email: enquiries@tuv-sud-psb.sg  
www.tuv-sud-psb.sg  
Co. Reg : 19900267R

Regional Head Office:  
TÜV SÜD Asia Pacific Pte. Ltd.  
1 Science Park Drive, #02-01  
Singapore 118221  
TUV\*

Test Report No. 7191166866-MEC17/4-YWA  
dated 21 Sep 2017



**Classification of Surface Spread of Flame**

Classification	Spread of flame at 1.5 min.		Final spread of flame	
	Limit (mm)	Limit for one specimen in sample (mm)	Limit (mm)	Limit for one specimen in sample (mm)
Class 1	165	165 + 25	165	165 + 25
Class 2	215	215 + 25	455	455 + 45
Class 3	265	265 + 25	710	710 + 75
Class 4	Exceeding the limits for class 3			

**CONCLUSION:**

In accordance with the class definitions specified in the Standard, the test results show that the sample tested has a Class One Surface Spread of Flame.

**REMARKS:**

The test results relate only to the behaviour of the test specimens of the product under the particular conditions of test; they are not intended to be the sole criterion for assessing the potential fire hazard of the product in use.

Ye Wint Aung  
Higher Associate Engineer

Ong Kian Huat  
Senior Associate Engineer  
Fire Property  
Mechanical

Test Report No. 7191166866-MEC17/6-YWA  
dated 28 Sep 2017



**DESCRIPTION OF SPECIMENS:**

Twenty pieces of specimen, said to be "Brand: "VIR", Model: "Type-EDF/EDS/EGF/EGS" (6mm thick x 1.45g/cm<sup>2</sup>) High-pressure decorative laminates (HPL) Exterior grade compact panel material comprising of Acrylic Film Layer for UV protection / Melamine Resin Treated Paper / Phenolic Resin Treated Kraft Paper / Melamine Resin Treated Paper / Acrylic Film Layer for UV protection, each of nominal test size of 125mm x 13mm were submitted. The Adhesive used was said to be Phenolic Resin and Melamin Resin for Kraft Paper and Design Paper Treating respectively. The Fire Retardant used was said to be Non Halogen, Phosphoric Base. The bulk density of the specimen was found to be approximately 1484kg/m<sup>3</sup>.

**RESULTS:**

Description	Unit	Result		UL 94 Requirement		
		After conditioning at 23 ± 2°C and 50 ± 5% RH for 48 hrs	After conditioning in an air-circulating oven for 168 hrs at 70 ± 1°C	V-0	V-1	V-2
20mm Vertical Burning Test						
1. Number of specimens tested		5	5			
2. After flame time after first flame application, t <sub>1</sub> (Individual readings)	sec	0, 0, 0, 0, 0	0, 0, 0, 0, 0	≤ 10	≤ 30	≤ 30
3. After flame time after second flame application, t <sub>2</sub> (Individual readings)	sec	0, 0, 0, 0, 0	0, 0, 0, 0, 0	≤ 10	≤ 30	≤ 30
4. Total after flame time for any condition set (t <sub>1</sub> + t <sub>2</sub> for the 5 specimens)	sec	0	0	≤ 60	≤ 250	≤ 250
5. After glow time after second flame application, t <sub>3</sub> (Individual readings)	sec	0, 0, 0, 0, 0	0, 0, 0, 0, 0			
6. After flame plus after glow time after the second flame application (t <sub>1</sub> + t <sub>2</sub> ) (Individual readings)	sec	0, 0, 0, 0, 0	0, 0, 0, 0, 0	≤ 30	≤ 60	≤ 60
7. After flame or after glow of any specimen up to the holding clamp	sec	No	No	No	No	No
8. Cotton indicator ignited by flaming particles or drops	sec	No	No	No	No	Yes

**CONCLUSION:**

In accordance with the criterion stated in the UL 94 : 1997 - 20mm Vertical Burning Test, the test results show that the sample tested meet the requirements for UL94 - 1997 V-0 classification.

Ong Kian Huat  
Senior Associate Engineer

Chan Lung Toa  
Product Manager  
Fire Property  
Mechanical

Classification Report No. 7191166866-MEC17/3-LGJ  
dated 22 Sep 2017



**4. Classification and field of application**

**4.1. Reference of classification**

This classification has been carried out in accordance with clause 11 of BS EN 13501-1: 2007 +A1: 2009.

**4.2. Classification**

The product, "VIR" exterior grade compact panel (6mm thick, 1.45 g/cm<sup>3</sup>), in relation to its reaction to fire behaviour meets the requirements to be classified as **B**.

The additional classification in relation to smoke production is: **s1**

The additional classification in relation to flaming droplets / particles is: **d0**

Fire behaviour	Smoke production	Flaming droplets
<b>B</b>	<b>s 1</b>	<b>d 0</b>

Therefore, the classification of "VIR" exterior grade compact panel (6mm thick, 1.45 g/cm<sup>3</sup>), in accordance with BS EN 13501-1: 2007 +A1:2009 is:

Reaction to fire classification: **B-s1,d0**

PROPERTIES OF VIR EXTERIOR  
GRADE COMPACT PANEL.



R  
DIN

## 1. UV Resistance

- Special UV protective film which is providing extra resistance to UV rays which are dwindling on the surface of Vir Exterior Grade Compact Panel. In combination with pure UV irradiation, our product is applied for condensation or water spray exposure. This type of test is normally used for initial screening to choose the best material.
- The discoloration of surface is prevented due to protective layers, which indirectly prevents fading of decorative design surface.
- Vir Exterior Grade Compact Panel complies with stringent testing as per European standard confirming to EN-438-6-28 for 1500 Hrs.

## 2. Artificial Weathering

- The weather testing process can be greatly accelerated through the use of specially designed weathering chambers. While this speeds up the time needed to get results.
- Product is subjected for testing in an advanced climate test facility from which, we can simulate any weather condition, whether natural conditions such as sunlight, salt mist, temperatures, rain, and combined exposures, or man-made conditions such as air pollution, chemicals, and extreme temperatures .hence our product meeting variant weathering conditions requirements.
- Vir Exterior Grade Compact Panel is tested for artificial weathering test with different environmental conditions. It complies to EN-438-6-27 & 29 with an appearance rating > 4.

## 3. Resistance to Climatic Shock.

- During a product's lifetime, it can be exposed to various climates – anywhere around the world – completely beyond your control or influence. Vir Exterior Grade Compact panels complies with stringent testing as per European standard confirming to EN-438-6-9. With good flexural strength & flexural modulus.
- Using specially tailored climate tests and test scenarios we help our customers to improve the robustness and reliability of our product – not just to comply with applicable design and performance standards, but also to fulfill consumer expectations.

## 4. Dimensional stability at Elevated Temperature.

Vir Exterior Grade Compact Panel is dimensionally stable under various extreme climatic conditions of temperature & humidity. It confirms to EN-438-6-17 the test performed for its evaluation at an extreme range of relative humidity at elevated temperature.

## Mechanical Properties of VIR exterior panel.

5. Panel Elasticity properties meet ISO-178, values achieved > 9000 Mpa which justify its strength & bending properties. Panel is not easily deformed elastically whenever external force is applied.
6. Flexural Strength: The flexural strength represents the highest stress experienced within the material at its moment of yield. It is measured in terms of stress or its stress load-bearing capacity which is observed to be more than 90 Mpa.
7. Tensile Strength: Ultimate tensile strength is measured by the maximum stress that a material can withstand while being stretched or pulled before breaking, Vir Compact Panel tends to achieve more than 70 Mpa when tested as per EN-ISO-527-2.
8. Density of Panel: Min 1.45 gram/cm<sup>3</sup>.

## 9. Reaction to Fire :

1. An EU classification serves as the standard of evaluation for the reaction to fire of construction and building materials. It establishes uniform Europe-wide requirements for fire protection in order to facilitate the unrestricted trade of construction products throughout Europe. In the EN 13501 Part 1 series of standards, the reaction to fire of construction and building materials is divided into several classes (Euro class A1, A2 and B through F). Evidence is provided in the form of a fire test conducted on the complete building element with a corresponding test certificate according to EN 13501 Part 2

2. Our Vir Exterior Grade Compact Panel complies with reaction to fire and is classified as Flame retardant classification, B, S2, D0. Our product meets the European standard requirements for building materials category. Key characteristics for the assessment of reaction to fire are: • Inflammability • Combustibility • Flame propagation • Smoke development • Dropping while burning.

CLASS	TEST PROCEDURE	CLASSIFICATION CRITERIA
B	EN-13823	FIGRA $\leq$ 120 W/s and LFS < edge of the specimen and THR600 s $\leq$ 7.5 MJ
B	EN ISO 11925-2 load = 30 s	Fs $\leq$ 150 mm (5.91") within 60 s

### Spread of Flame:

FLAME EXPOSURE » 30 KW; THE SBI TEST MEASURES:

• The release of energy (THR – total heat release) • The spread of flames (LFS – longitudinal flame spread) • The speed at which the fire spreads (FIGRA – fire growth rate) • Smoke development (SMOGRA – smoke growth rate) • Dripping / dropping while burning

Vir Exterior Grade Compact Panel (FR GRADE) complies to Class -1 when tested for spread of flame.

### Special Features & advantages of using Vir Exterior Grade Compact Panel.

1. Waterproof against rain, frost, snowfall.
2. Act as sound barrier.
3. Solvent resistant
4. Resistance to Impact.
5. Lesser Time & Easy to Install at site
6. Enhanced Light fastness
7. Cleaning is Easy
8. Protect wall surface from external heat, hence reduced thermal conductivity rate.
9. Both side special UV protective Acrylic film, prevents decorative surface from fading effect.
10. Panel can be used for both vertical & horizontal panel alignment.
11. Surface with Anti-graffiti property.
12. 100 % corrosion free product.
13. High stability in variant Environment across globe.



# ENDURE



## EXTERIOR COMPECT HPL CONSTRUCTION

NOT ONLY BEAUTIFY BUT ALSO KEEPS EXTERNAL WALL COOL THUS PREVENT EXTERNAL HEAT TO COME INSIDE. ADVANCE EWC PREVENT DIRECT HEAT TO FALL ON BASE WALL THAT PROVIDES MORE COMFORTABLE ENVIRONMENT & SAVES THE SIGNIFICANT ENERGY.

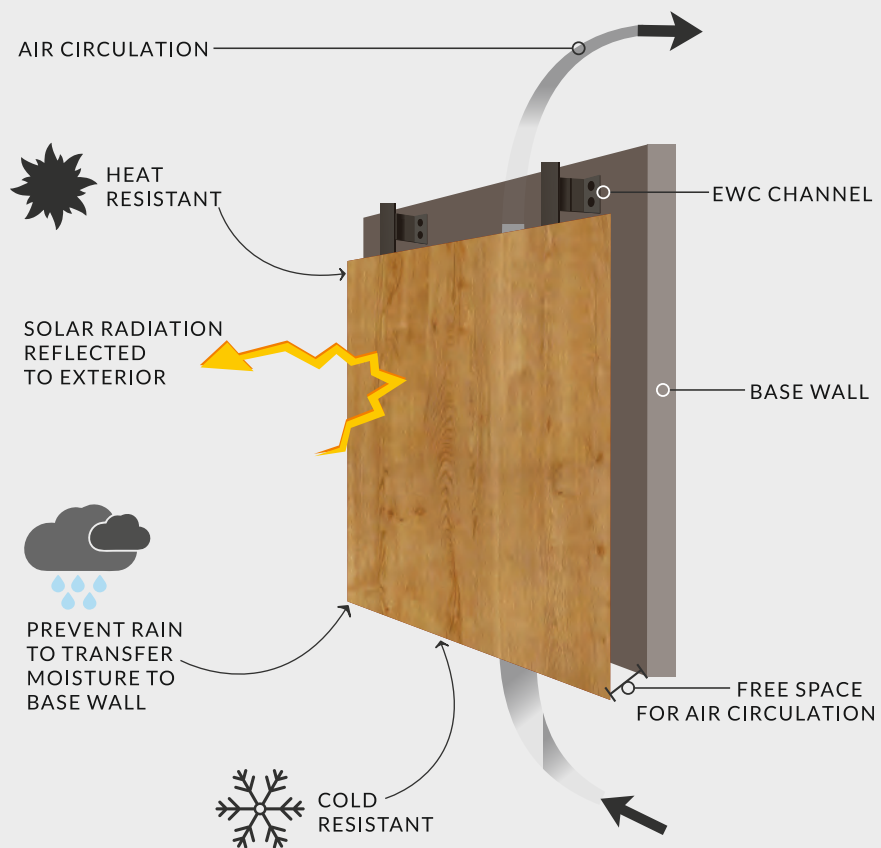

# WARRANTY FOR KLADS

Rushil Décor Ltd product offering Exterior grade compact panel endorses & confirm to EN-438-6 provided for a Limited warranty period of 10 Years.

This warranty covers on products for any Delamination in panel.

Slight loss of brightness or homogeneous variation in color occurring during course of time in use is acceptable as per EN-438-6 Std.

The warranty is evoked with immediate effect on the sale of the products to the first consumers, purchaser whose name & details are mentioned in the invoice. The warranty on our products is non-transferable. These terms of warranty shall be deemed to have accepted upon purchase of product by first consumer purchaser

Our warranty shall not cover any damage or deviation from the Std 438-6 upon normal wear and tear or in the event products are spoiled as a result of miss use, mishandling, neglect, accident, improper application, extreme temperature, improper fabrication leading to deformation, installation, improper maintenance. This warranty shall be void subject to other terms & conditions contained herein, upon non production of the original warranty documents.

Rushil Decor shall have the sole & absolute right to determine the reason for such damage or deviation. We shall have the right to inspect our supplied any products claimed as a defective product at the buyer's premises, or require the buyer to return the product to us only if such products are proven to be defective and not confirming to std EN-438-6, as covered by this warranty. And are returned within the warranty period stated above. In case of any claims, quarrels the obligation of Rushil Decor Ltd. to purchaser/buyer under this warranty is however limited to the repair/servicing/replace of the unit only, when the product is returned back to retailer upon forwarding original warranty documents with invoice copy.

Our Authorized dealers are our mutual partner in supporting the warranty requests. The company Rushil Décor Ltd. shall not entertain any direct claim/service.

To obtain service under this warranty, please contact our authorized Dealers.

# INSTALLATION TYPES

2 EASY AND QUICK SCHEMATICS  
TO INSTALL VIR KLADS



**ADHESIVE**



This uses a 3M adhesive to fix the panel. It gives a clean look and is relatively cheaper.



**RIVETED**



It uses a PU coated rivet and is a more trusted and extensively tested method. It makes the panel strong and durable.



  
**VIR**  
KLADS

# KLADS

9107  
Arkan Wood

# WOOD GRAINS

Crafted For  
*Comfort*

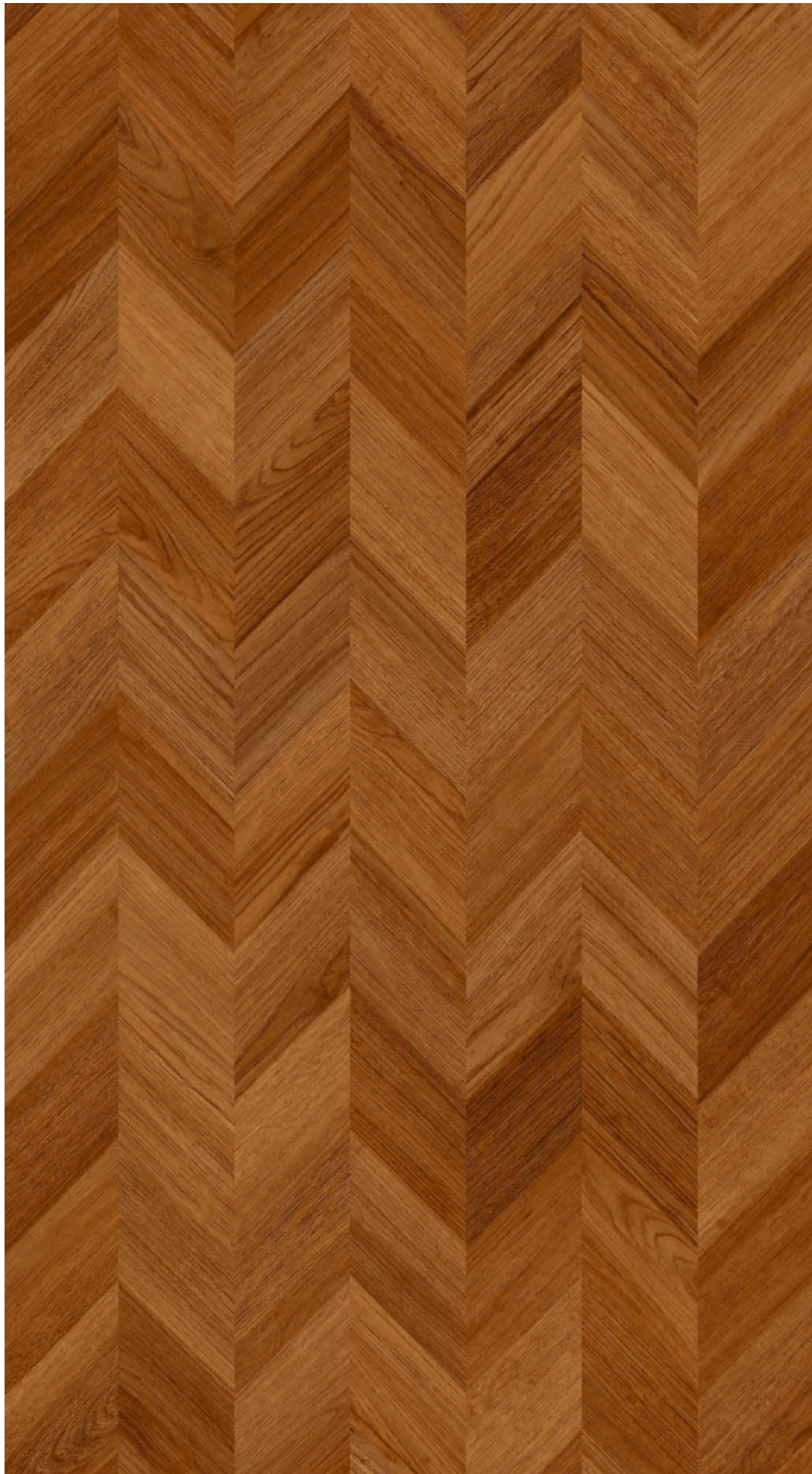

9342 | Woodland Zigzag



W O O D L O O K , F U T U R E R E A D Y



Invest in everlasting exteriors that reflect sophistication

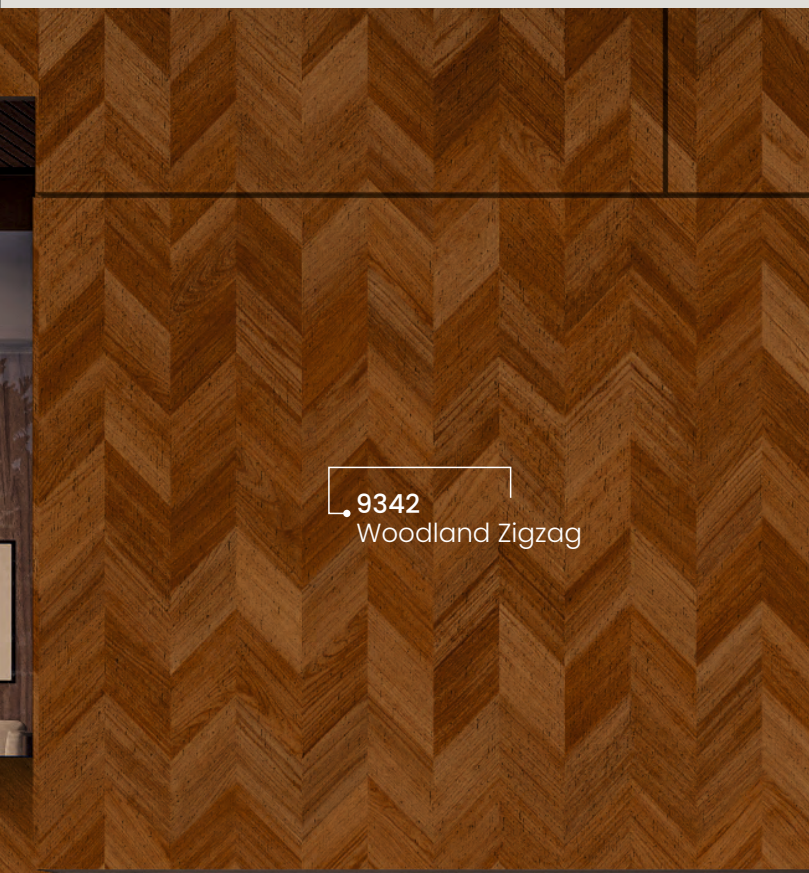

9342  
Woodland Zigzag



8677 | Greta Light

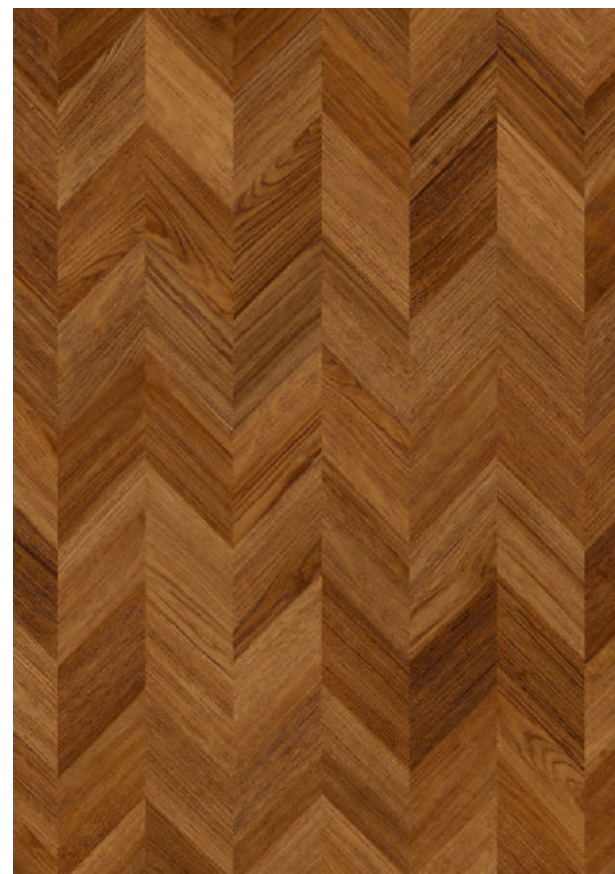

9343 | Brown Wave



9341 | Rustic Chevron



8678 | Greta Dark



# WOOD GRAINS

# SHIELD

Weatherproof  
*Warmth*



4136 | Wenge Teak

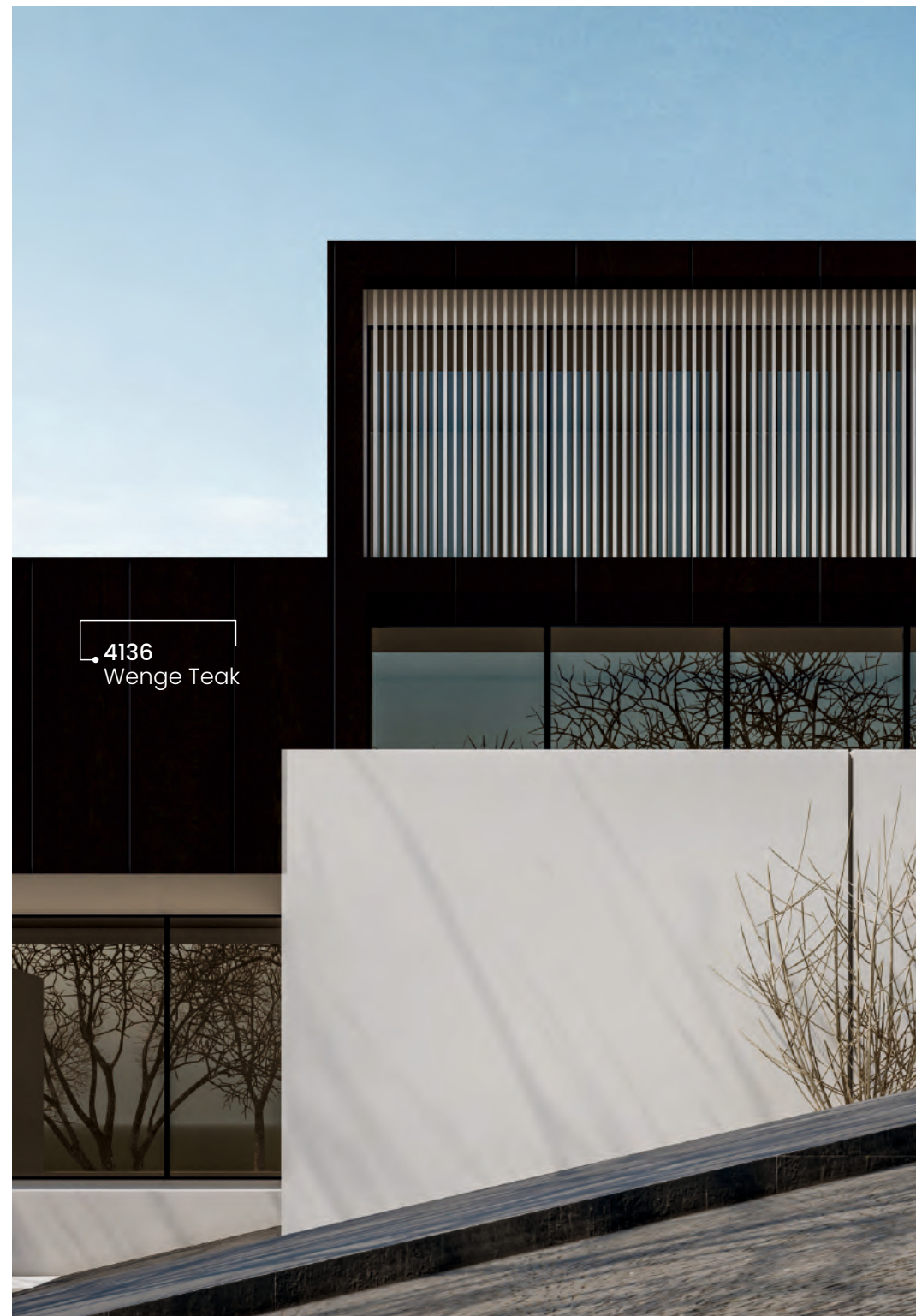

G R A I N T H A T L A S T S

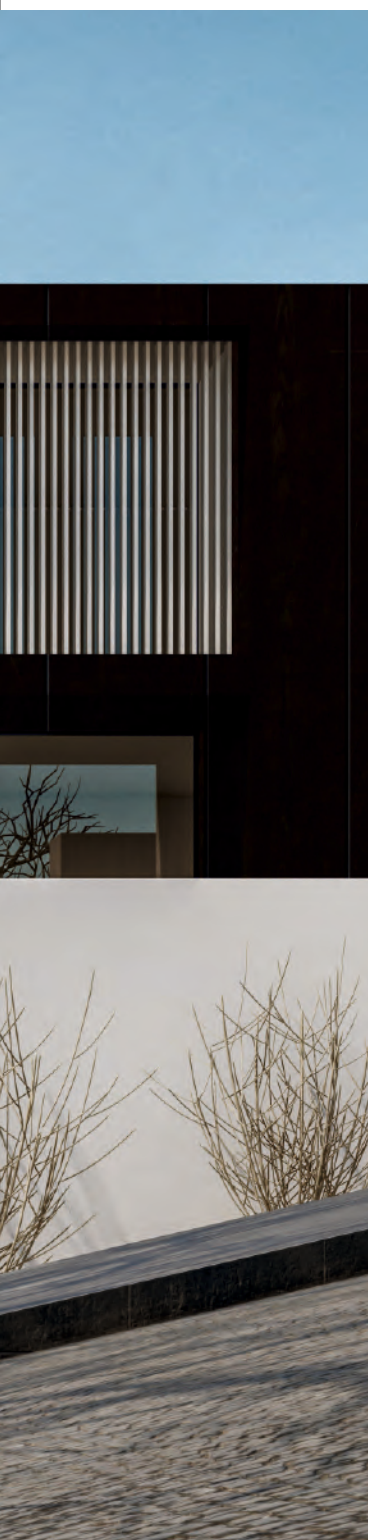

4152 | Coventry Akazie



4164 | American Cherry



# MARBLES

F E E L T H E S U R F A C E



## Built on *Stone*

Design exteriors that  
define your vision

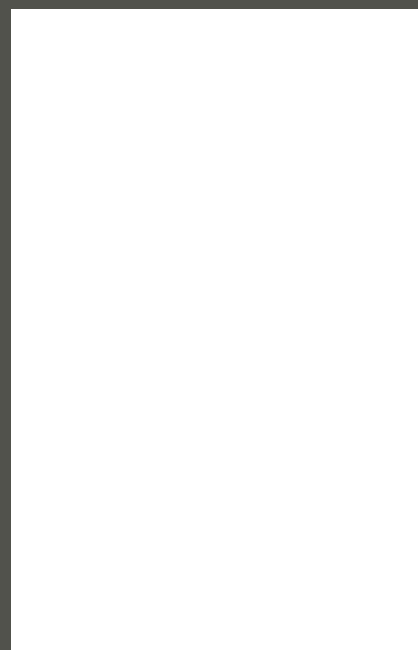

1051 | Crystal White



4602  
Greystone

4602 | Greystone





8569 | Kamala

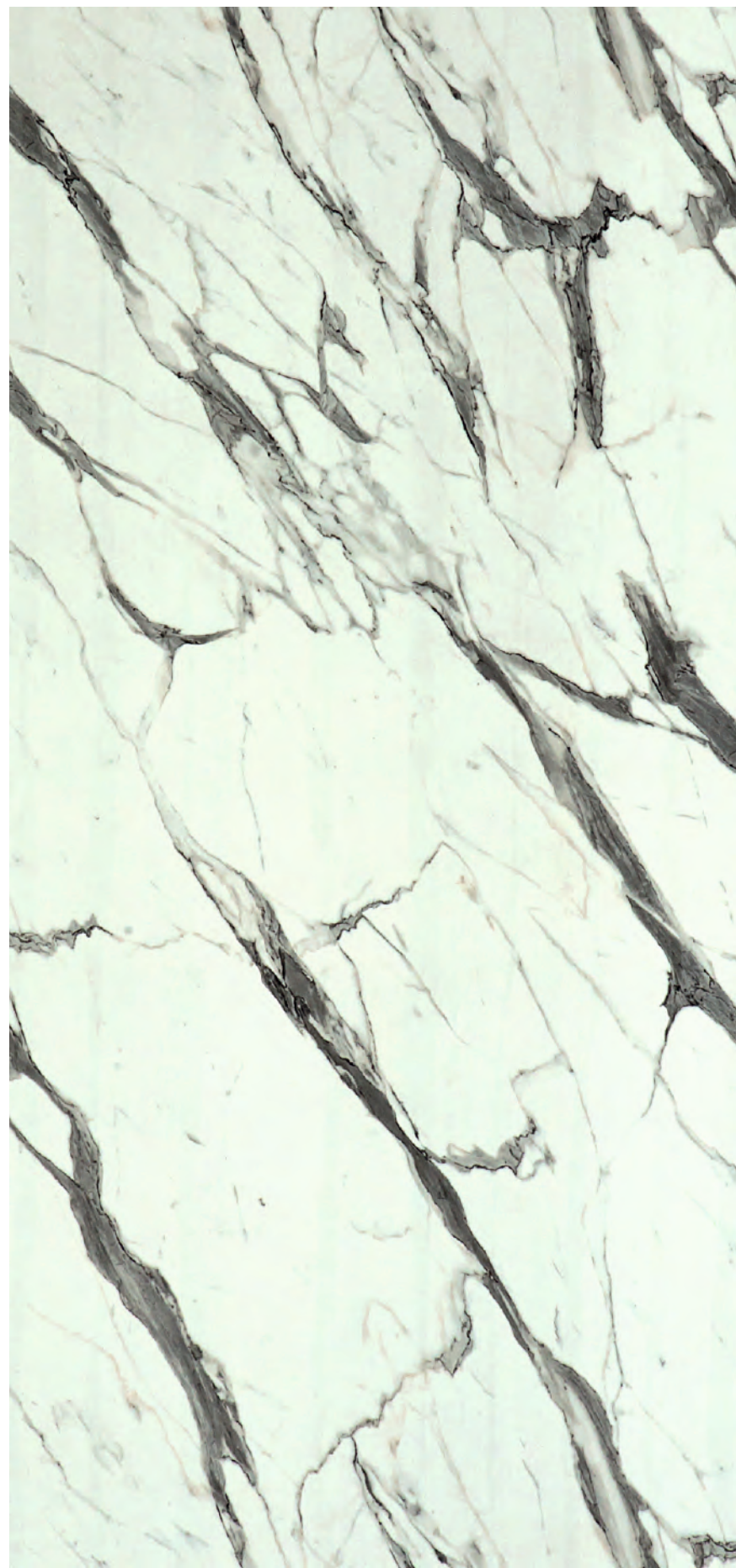

8582 | Bonito



# MARBLES

Exterior Strength  
Marble Touch



8653  
Perito



8654 | Zebra Marble



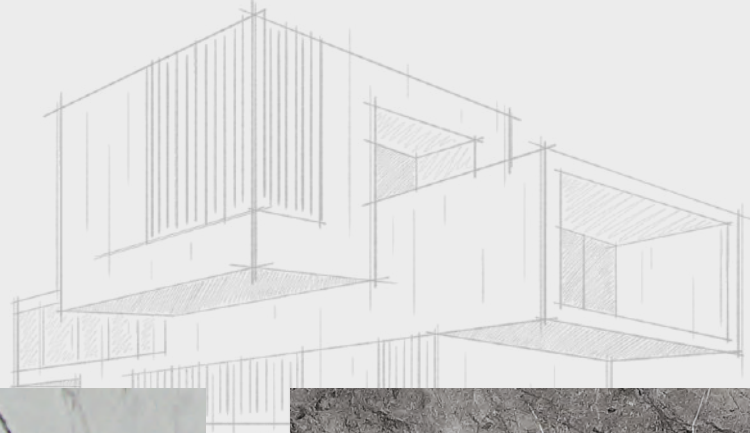

8653 | Perito



8656 | Sinope Marble



# MARBLES

---



8697 | Travertin Light



8698 | Travertin Dark



Invest in everlasting exteriors that  
reflect sophistication

# Crafted For *Comfort*

  
KLADS



8663 | Venice



# GLITTER

---

## Rock-Solid *Beauty*

A bold mix of glamour,  
grit and design.



8801 | White Glitter



8802 | Burgeon Glitter



8803 | Brown Glitter



8804 | Titanio Glitter



8805 | Dark Grey Glitter



# LEATHER

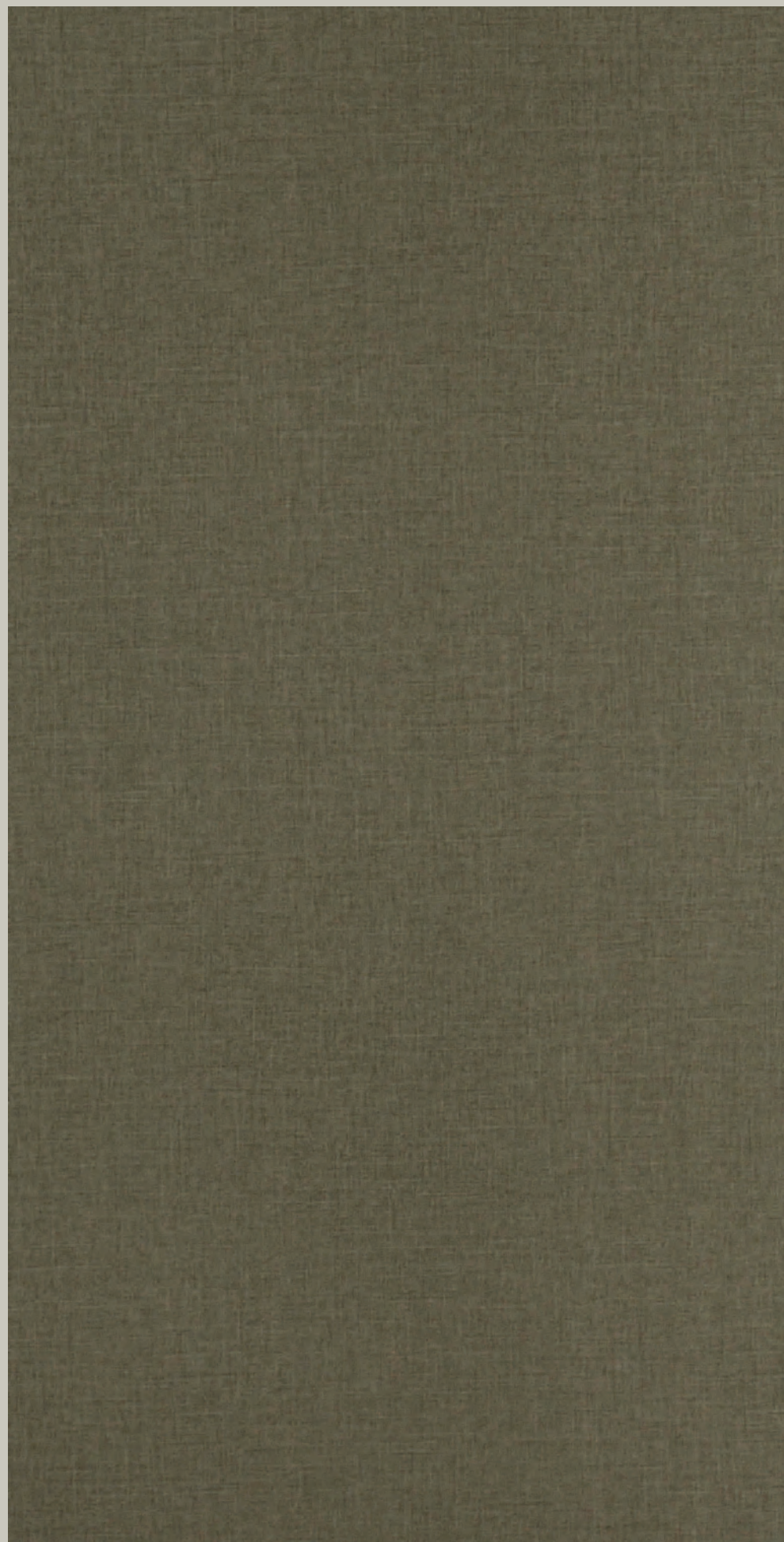

8623 | Misty Bronze

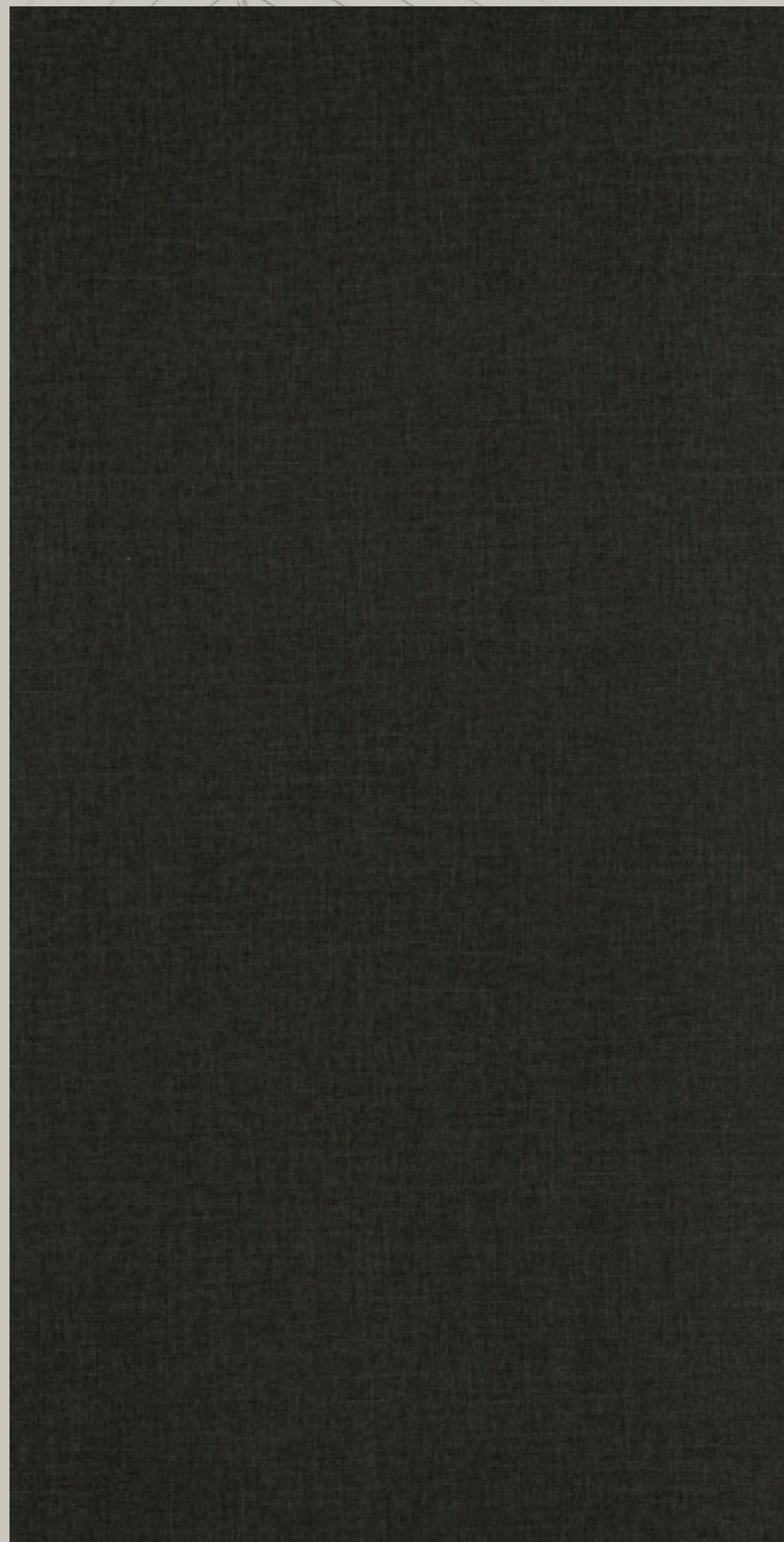

8624 | Twist Dark Grey



# MARBLES

Engineered for  
*Exteriors*

D E S I G N T H A T P E R F O R M S



12508 | Travertino Grigio Light



12509 | Travertino Grigio Dark



12510 | Green Alta Gris





3100 | Paris Brown



9322 | Calacatta Elegance



9324 | Tuscany Grey



3200 | Paris Grey



9323 | Arabescato

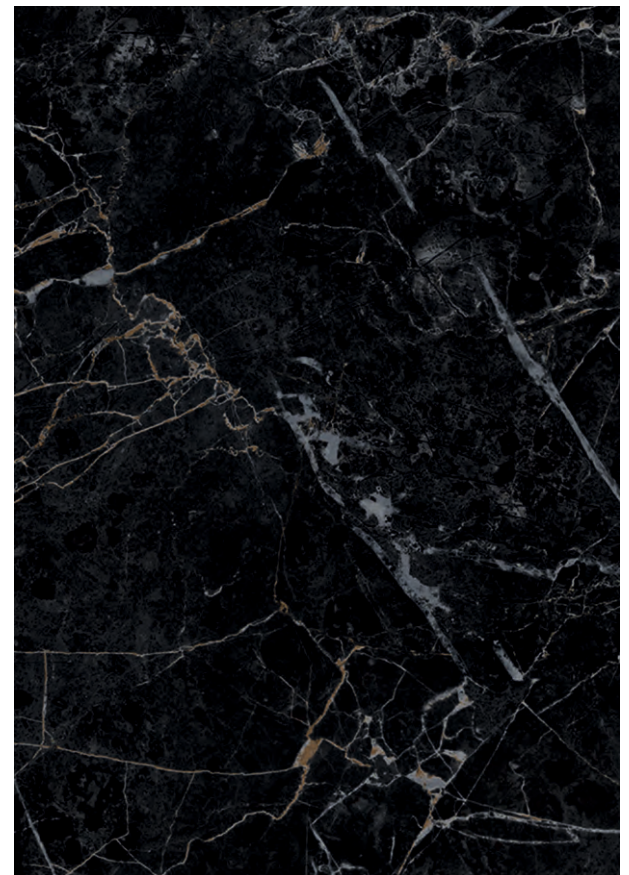

9325 | Midnight Fortress



# MARBLES

KIADS

P E R F O R M A N C E O U T S I D E



9326 | Midnight Onyx



9327 | Grigio Carnico



9306 | Coral Stone



Texture That  
*Performs*

Enduring beauty,  
crafted for the outdoors.



9328 | Graphite Grey



9329 | Charcoal Marble



9330 | Pietra Grey



# MARBLES

---



9331 | Khaki Carrara



Elevate exteriors with thoughtful design.

Designed to  
*Endure*



9332 | Stormy Stone



# WOOD GRAINS

Strength That Moves  
With Style.



**VIR**  
KLADS



117 | Bunty Oak



401 | Burma Teak



8694 | Brentwood Oak



8696 | Ardent Oak Dark

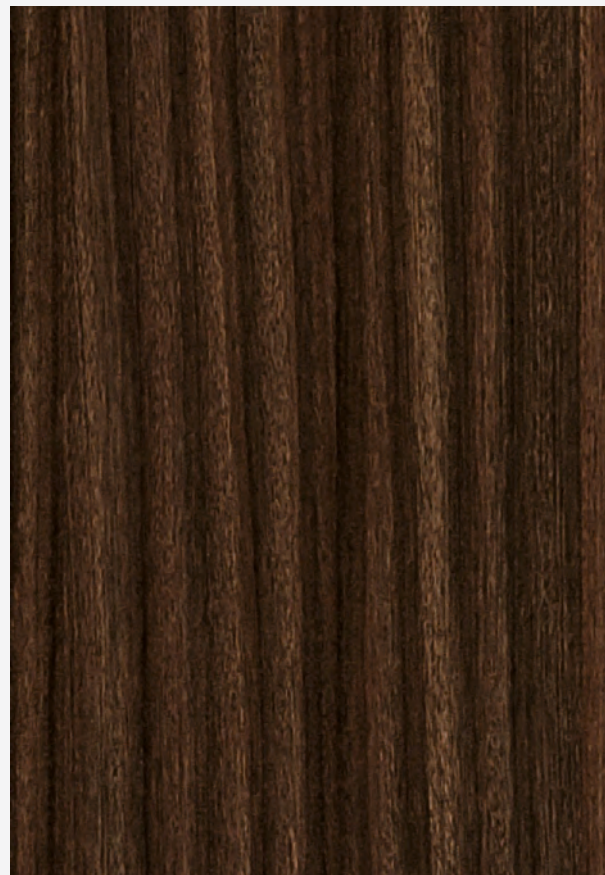

9106 | SAVALL Mahogany



9107 | Arkan Wood



D E S I G N T H A T P E R F O R M S

# WOODGRAINS



1121 | High Land Pine



8643 | Odin Eiche Light



1130 | Bavarian Beech



8644 | Odin Eiche Dark

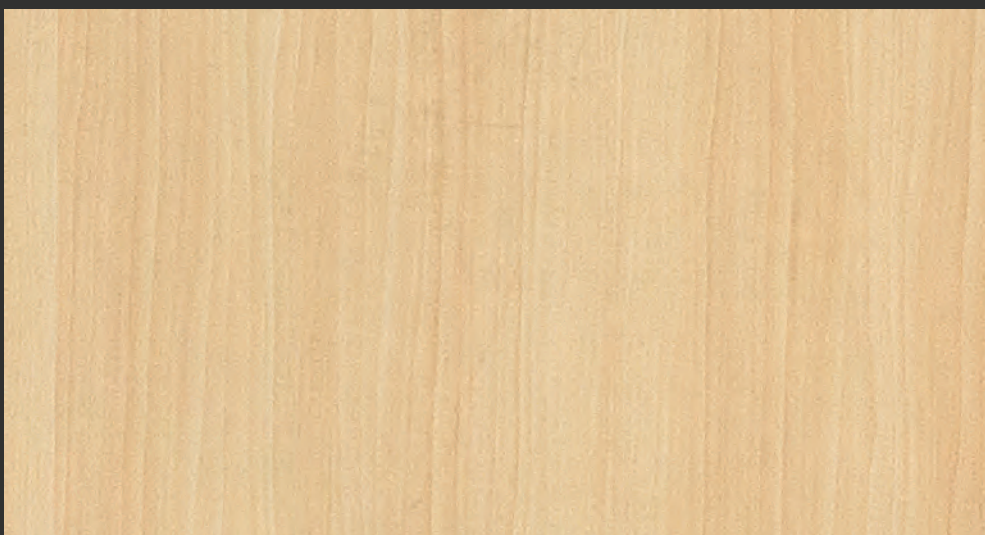

1171 | Ice Pear



8651 | Bratty Oak Grey



Wood-inspired finishes,  
crafted for timeless facades.

# Bold Wood *Looks*



1175 | Nice Wood



# WOODGRAINS



1176 | American Maple



1200 | Teak Cantabria



6101 | Light Nordic



1400 | Walnut Tiepolo

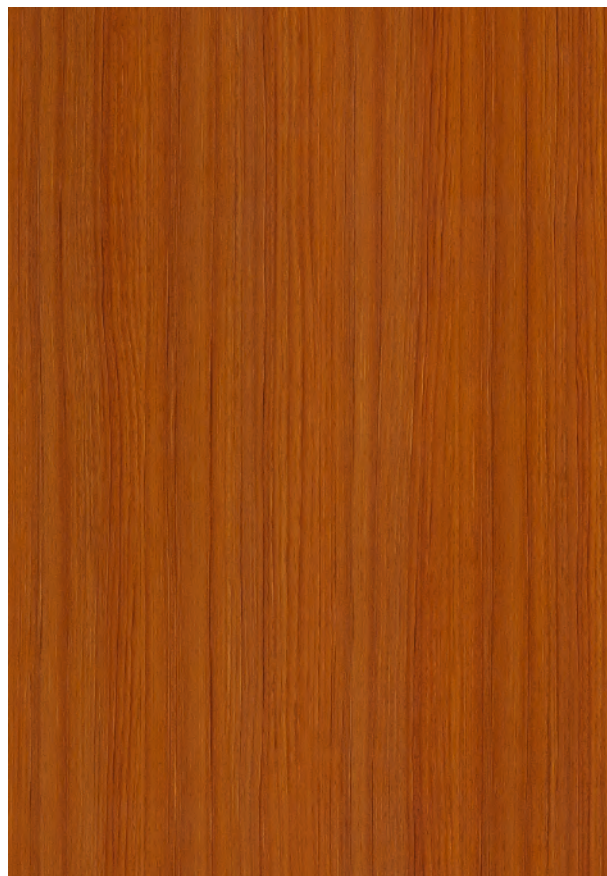

2129 | Madras Teak



6129 | Sea Beech





2164 | Malasian Cherry

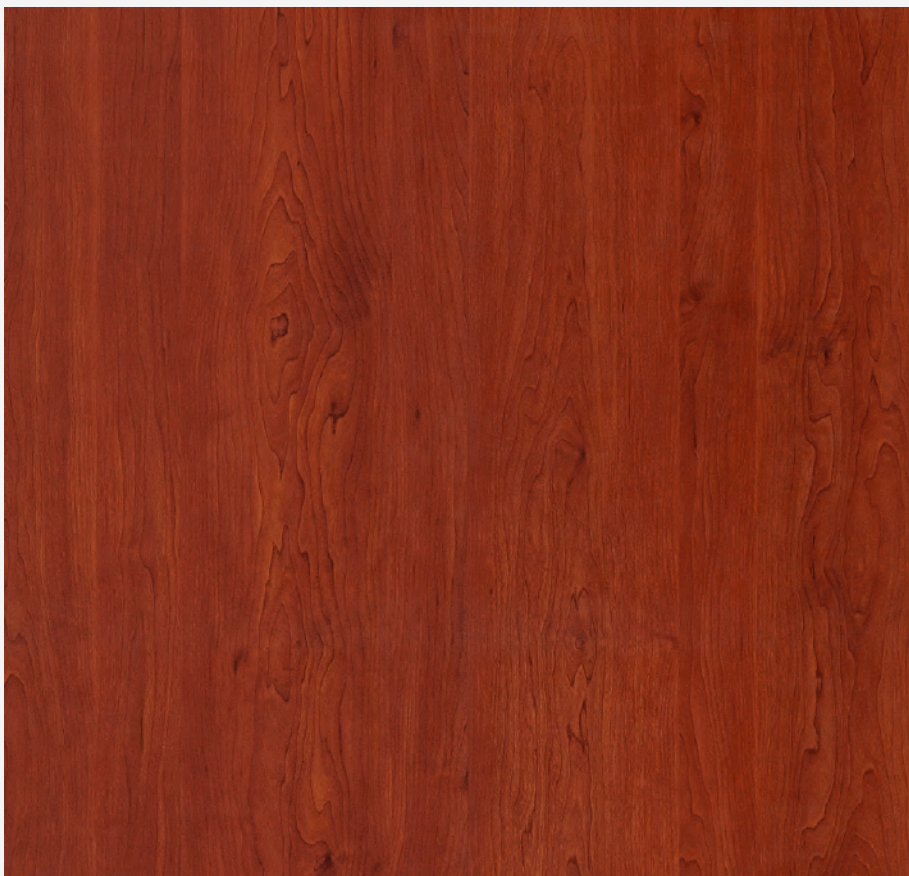

2174 | Vancouver Ahora



2221 | Mild Beech

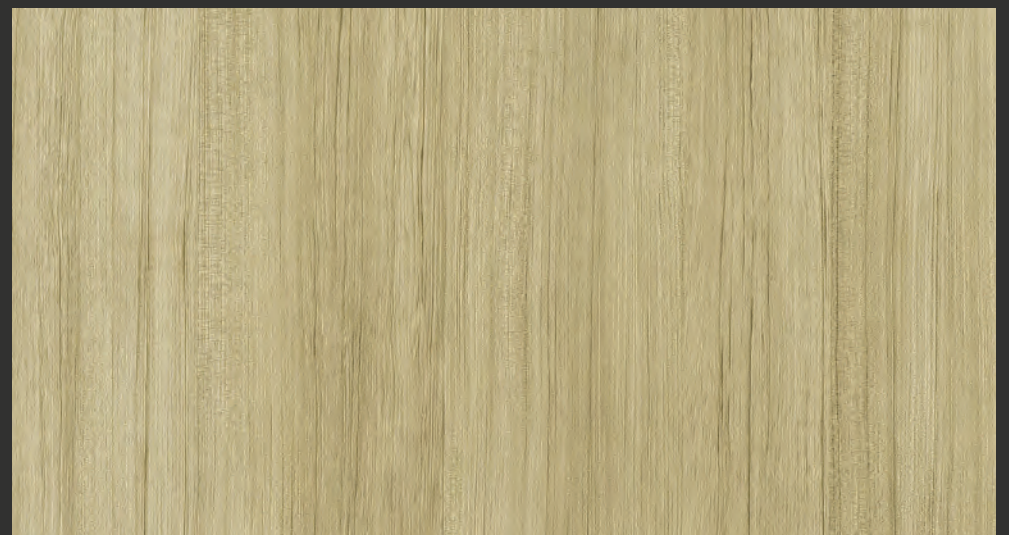

8113 | Rushil Teak

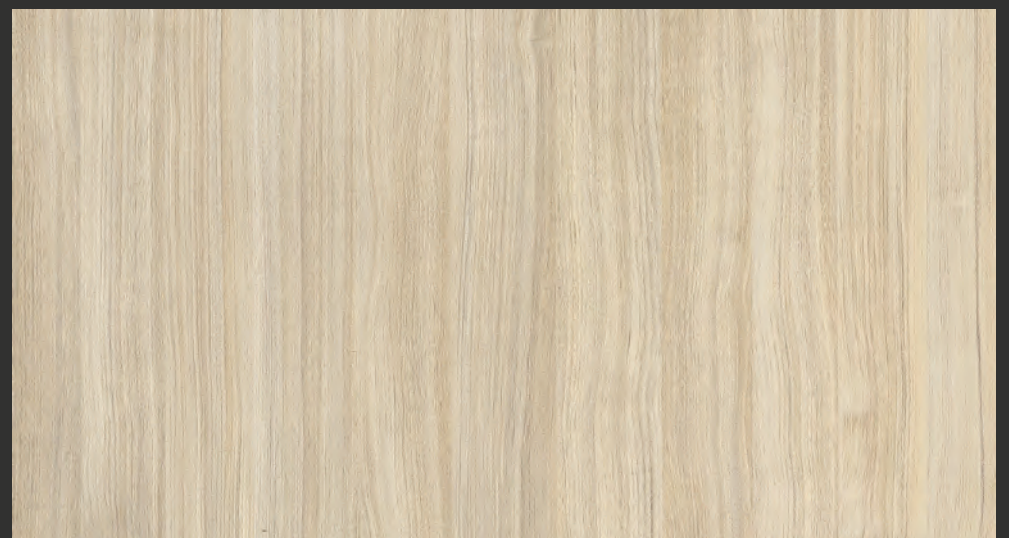

8116 | Luminosity Walnut



# WOODGRAINS



3152 | Moldau Acacia



3311 | Lynar Maple

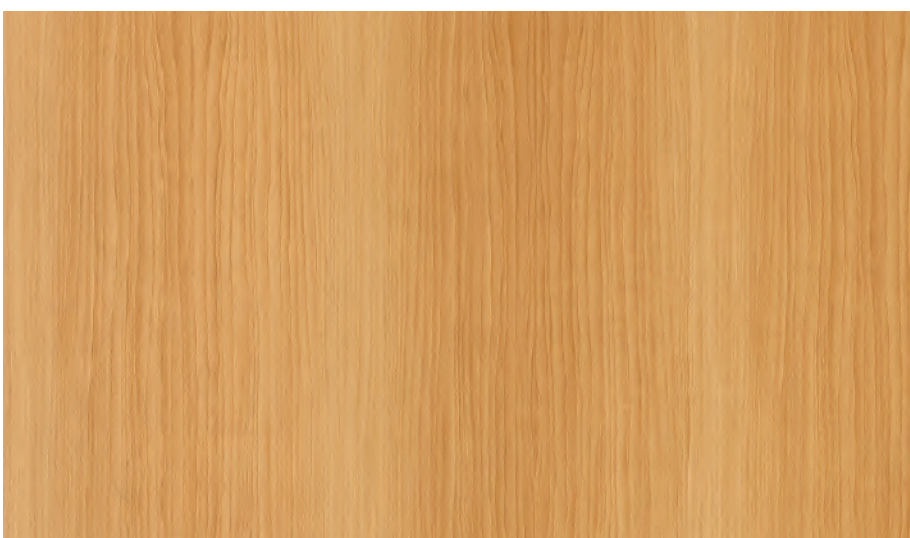

7171 | Nice Pear Wood





R E D E F I N I N G O U T D O O R S

Exteriors that inspire awe with their captivating presence

Styled for  
*Outdoors*

  
VIR  
KLADS



5137 | Walnut Classic



5180 | European White Elm



8692 | Teak Indonesia



8693 | Pasture Walnut



# WOODGRAINS

Exteriors that inspire awe with  
their captivating presence



8117 | Mysterious Walnut



Texture That  
*Performs*

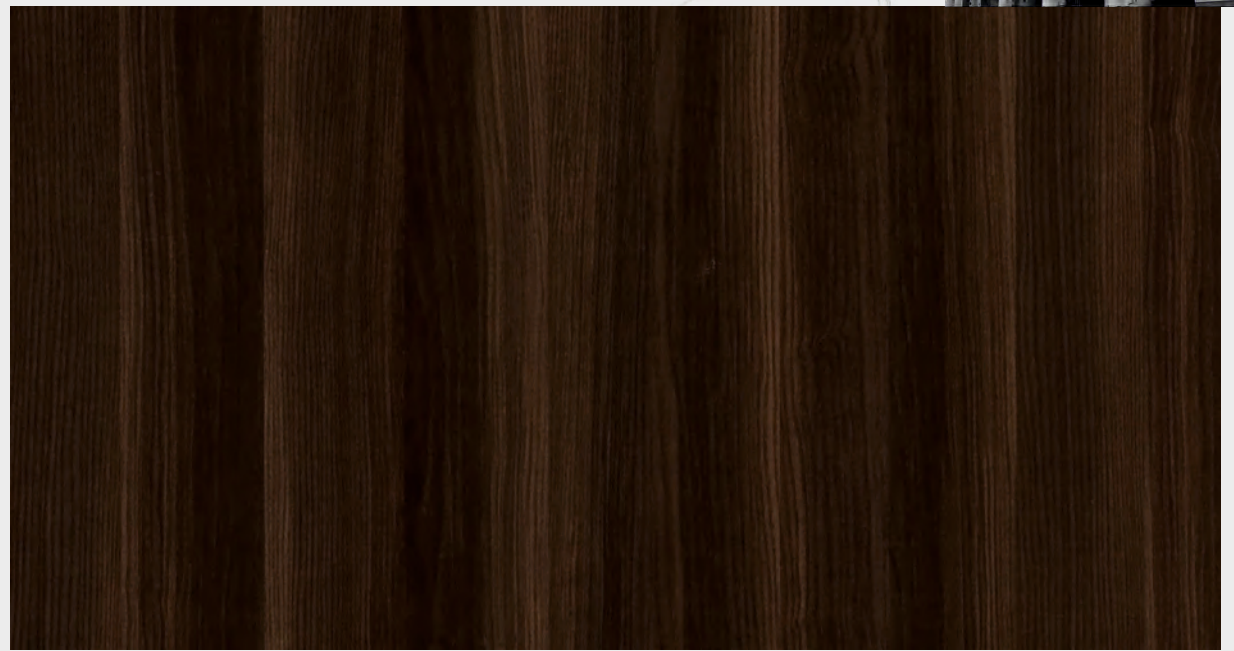

8118 | Rigato Walnut

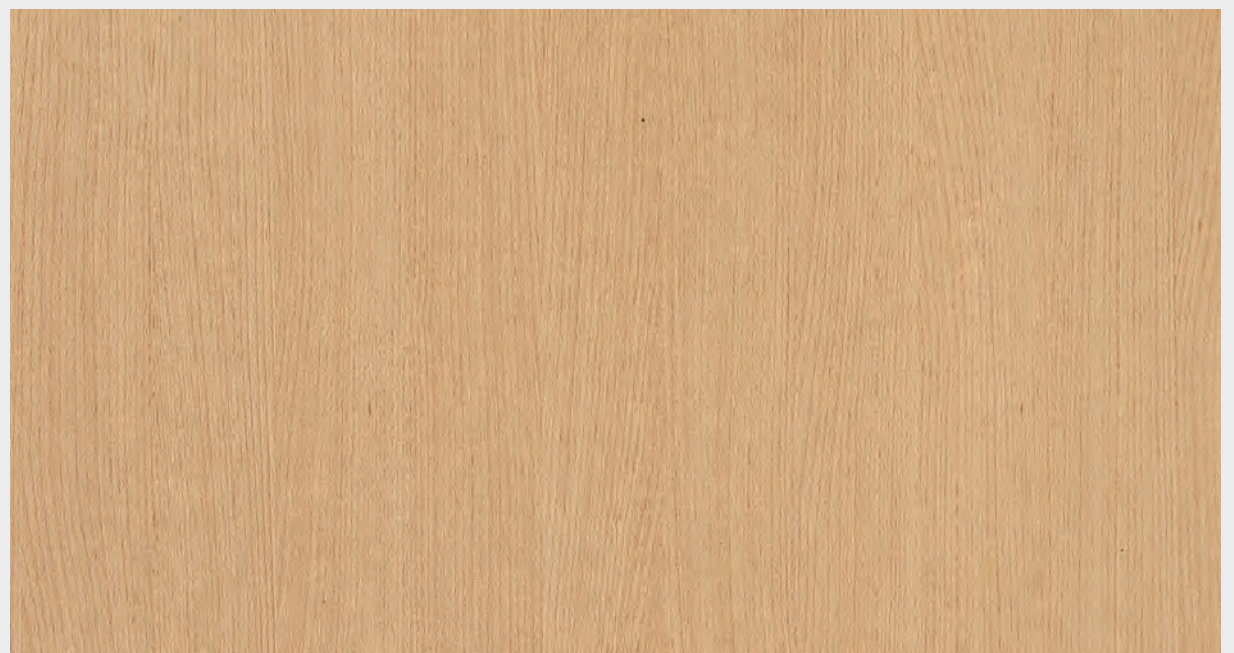

8129 | Princess Beech





8136 | Kampla Wenge

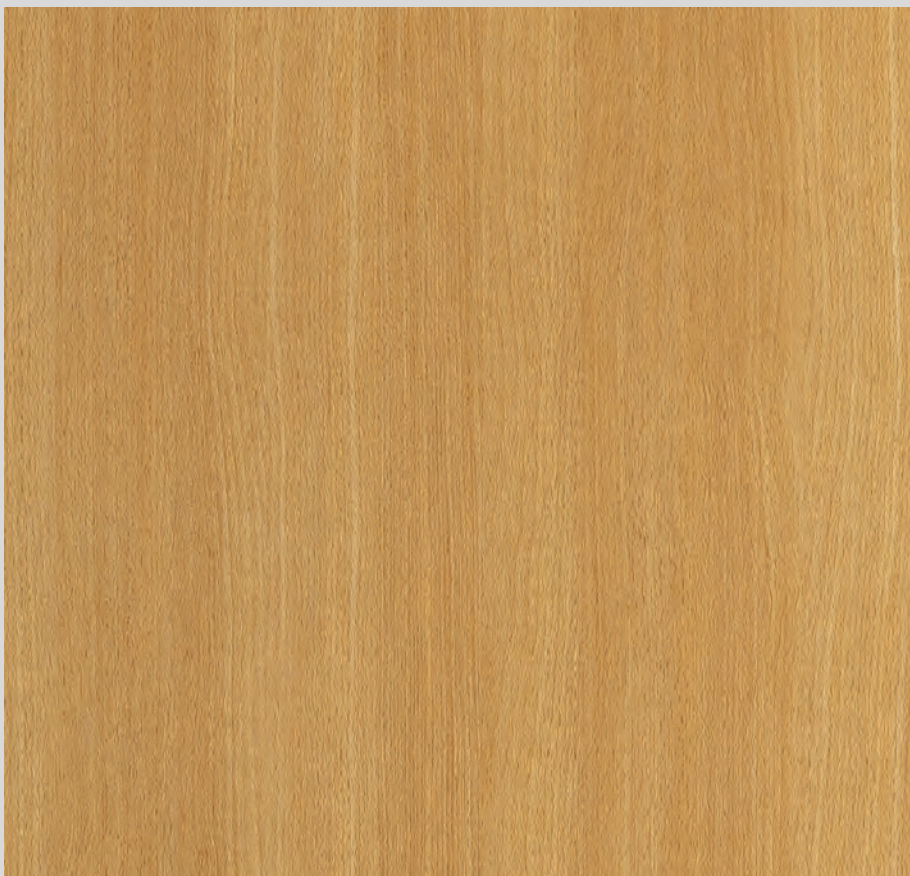

8140 | Japan Beech



8145 | Storm Wood

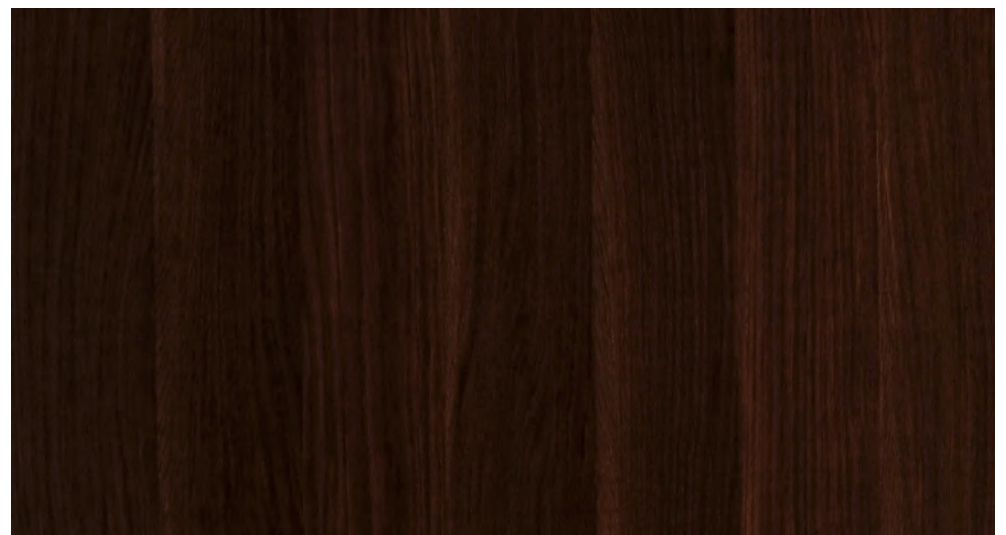

6102 | Cherry Nordic

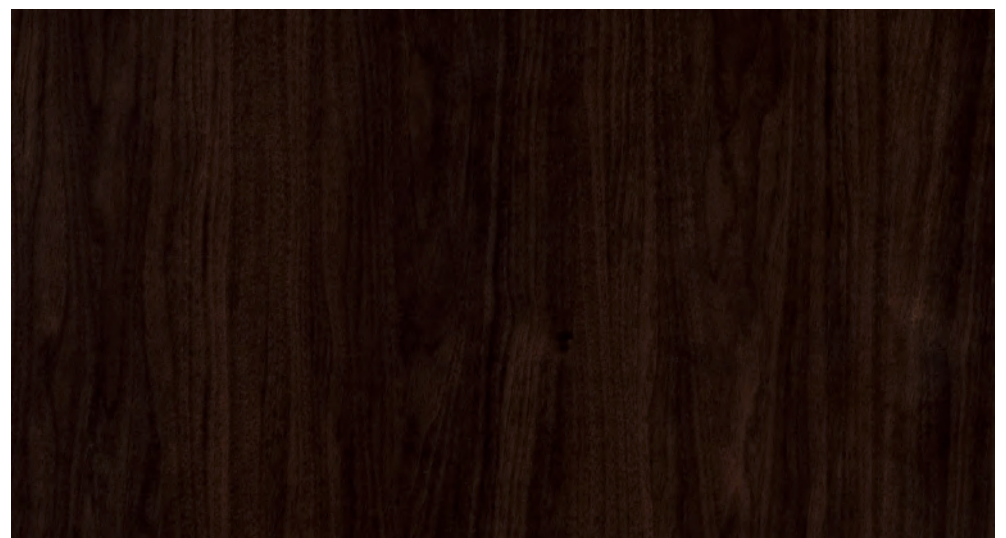

6146 | Noce Soleri



# WOODGRAINS



8146 | Vintage Wood



Design exteriors with the  
beauty of real wood.



8147 | Country Pear

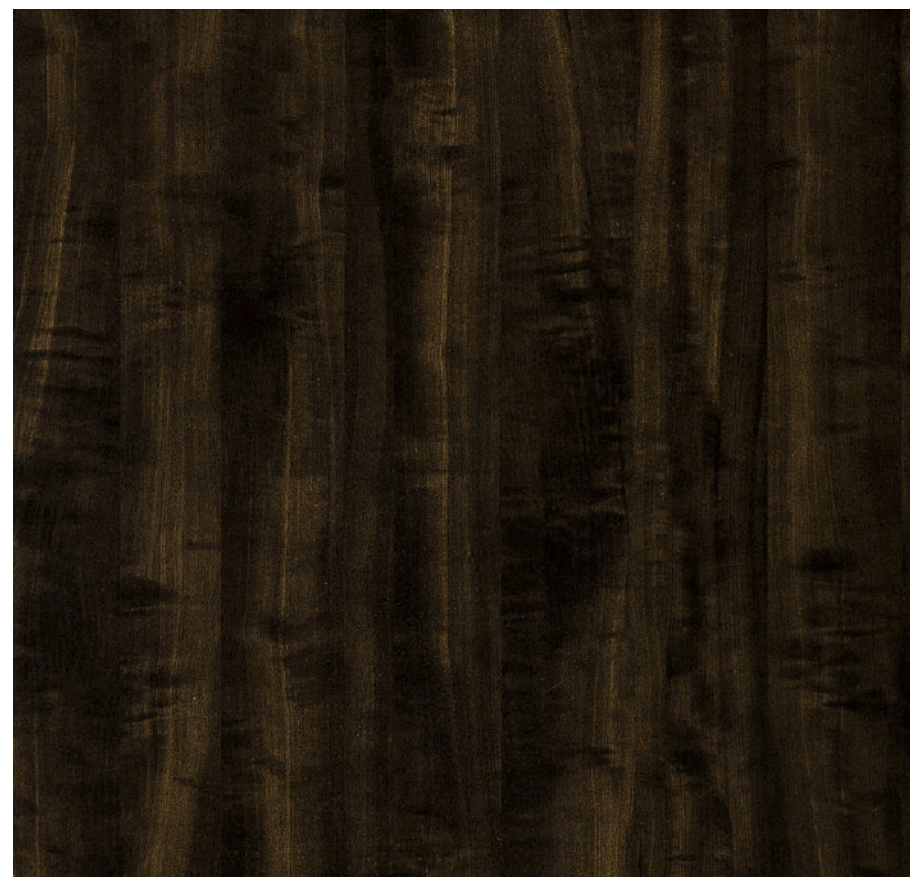

8149 | City Pear



8151 | White Rushil Wood

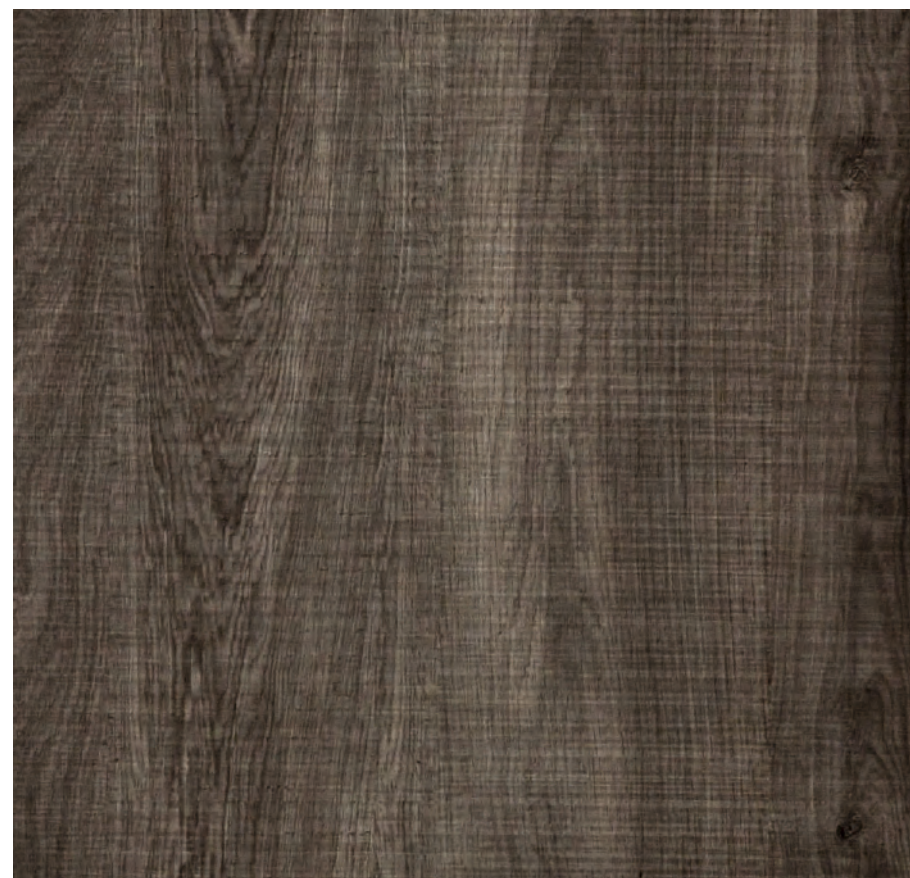

8162 | Smoked Oak



# WOODGRAINS

---



8163 | Chalked Oak



8515 | Choco Planked Walnut



8179 | Thames Oak

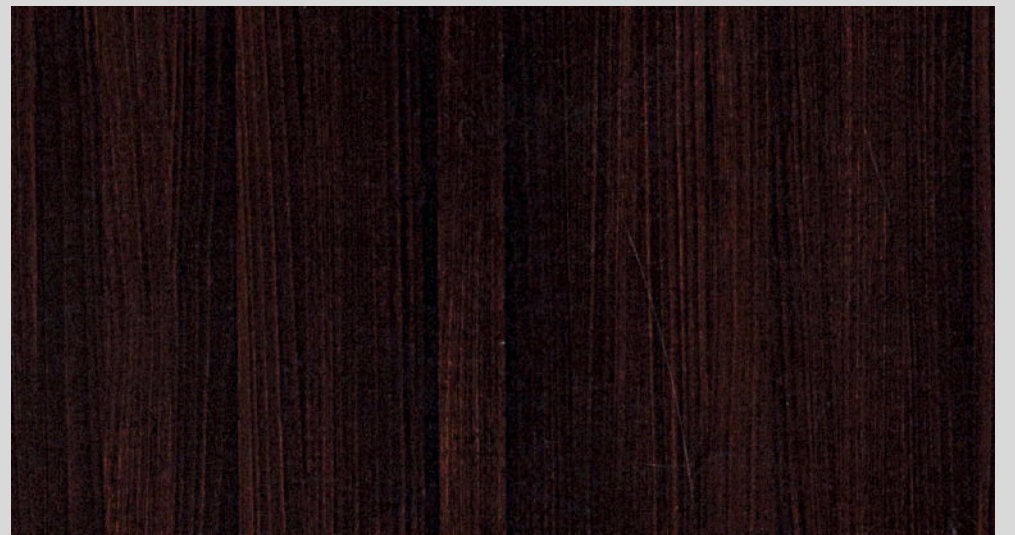

8516 | Atlas Planked Walnut

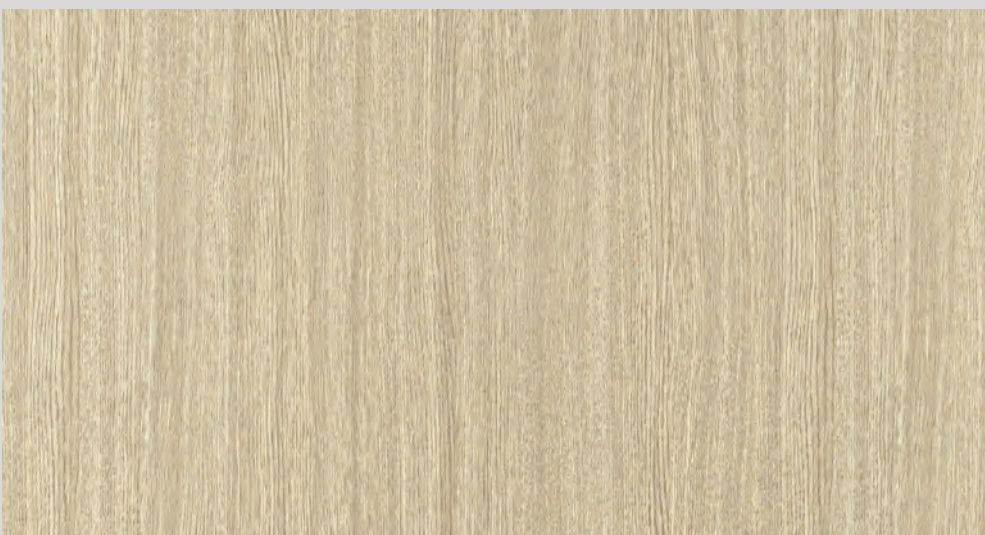

8189 | Prima Oak

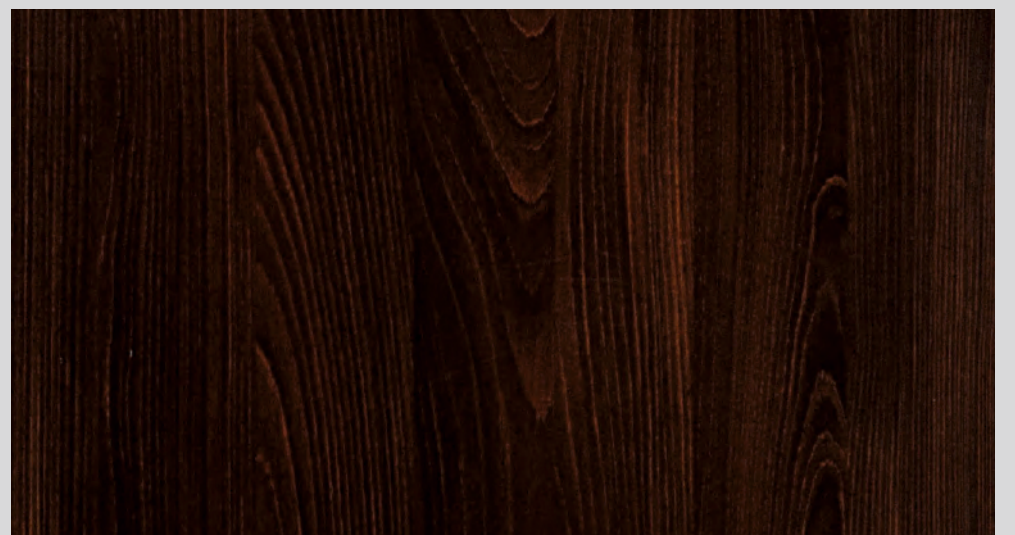

8523 | Dark Eminence



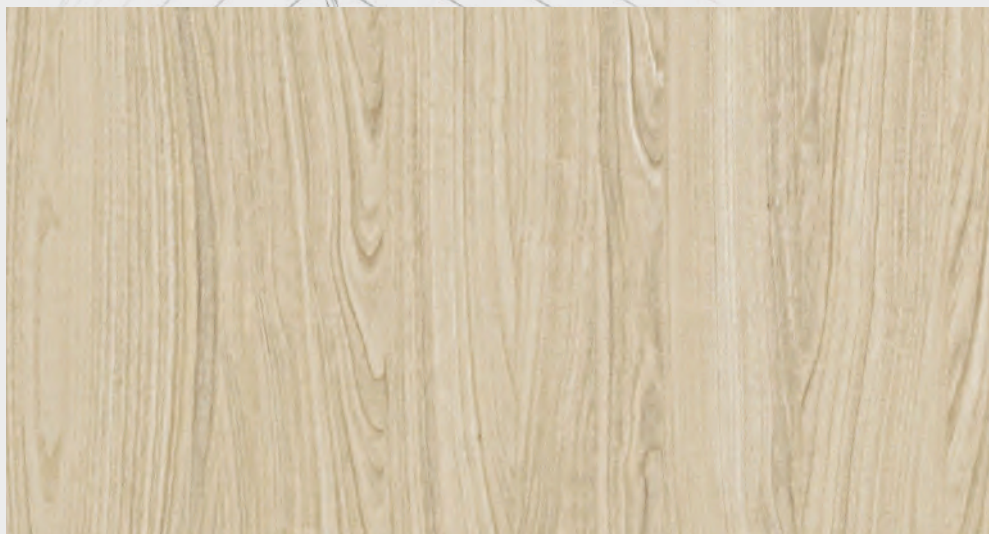

8526 | Light Arctic Birch



8529 | Angola Walnut Brown

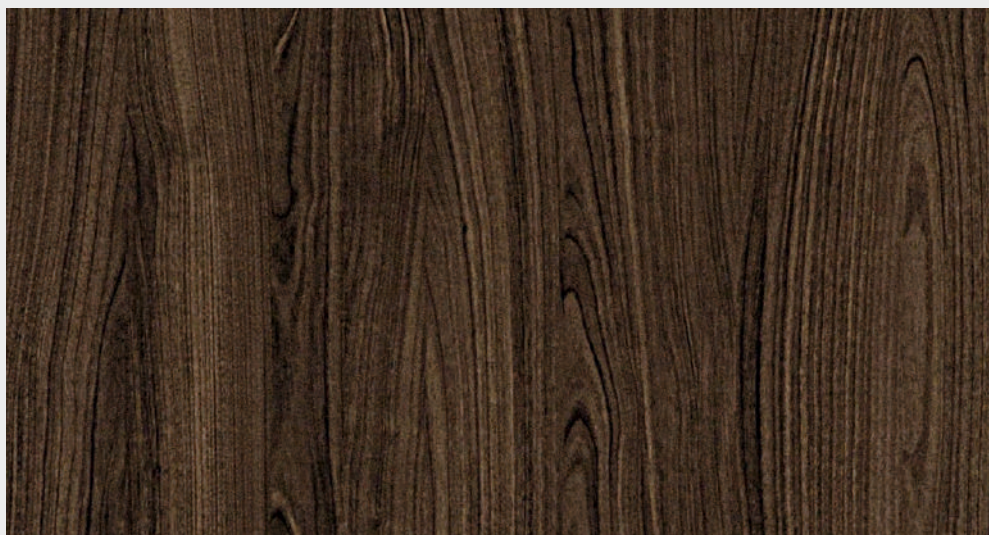

8527 | Dark Arctic Birch

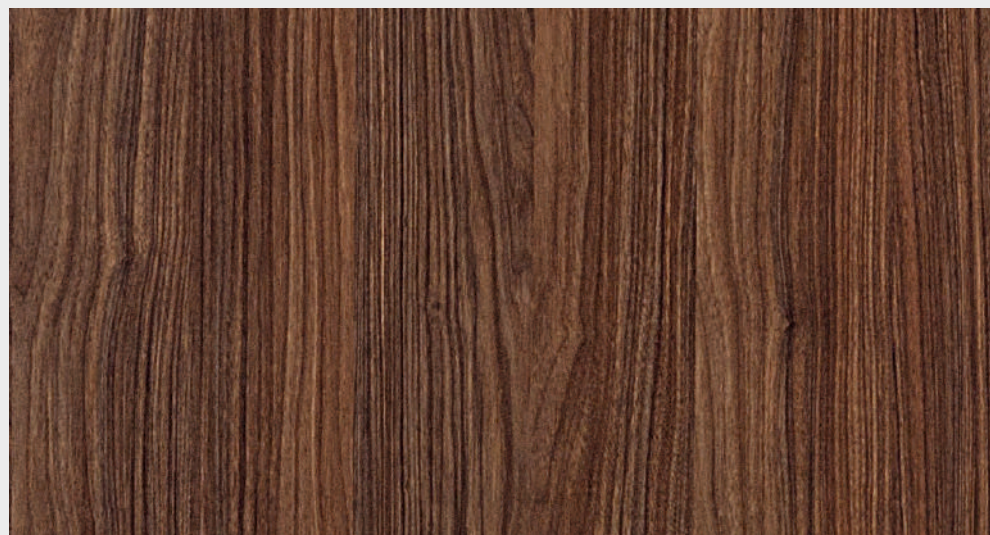

8530 | Angola Walnut Dark

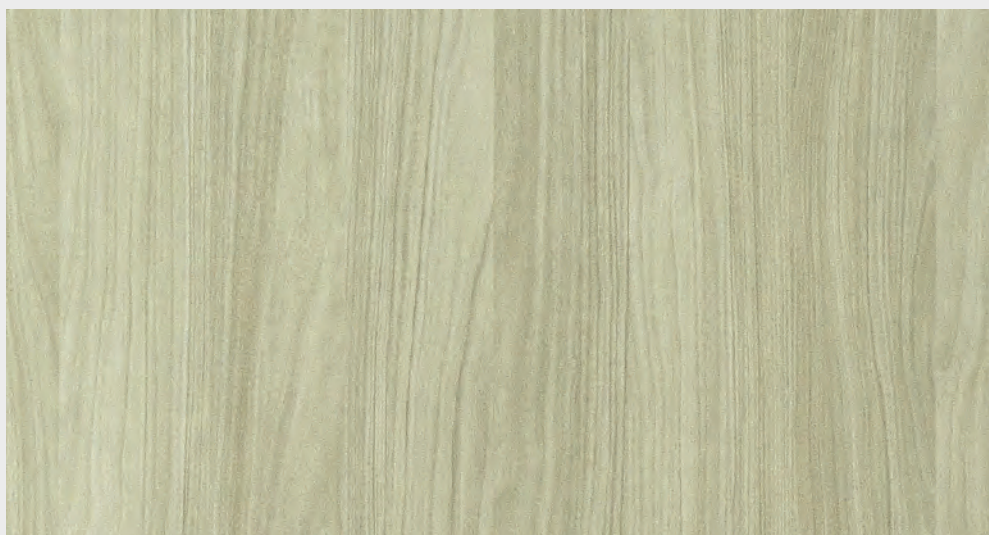

8528 | Angola Walnut Light



8534 | Merapi Walnut



# WOODGRAINS

---



8536 | Canyon Wood Light



8585 | Vintage Pine Light



8537 | Canyon Wood Dark



8586 | Vintage Pine Dark

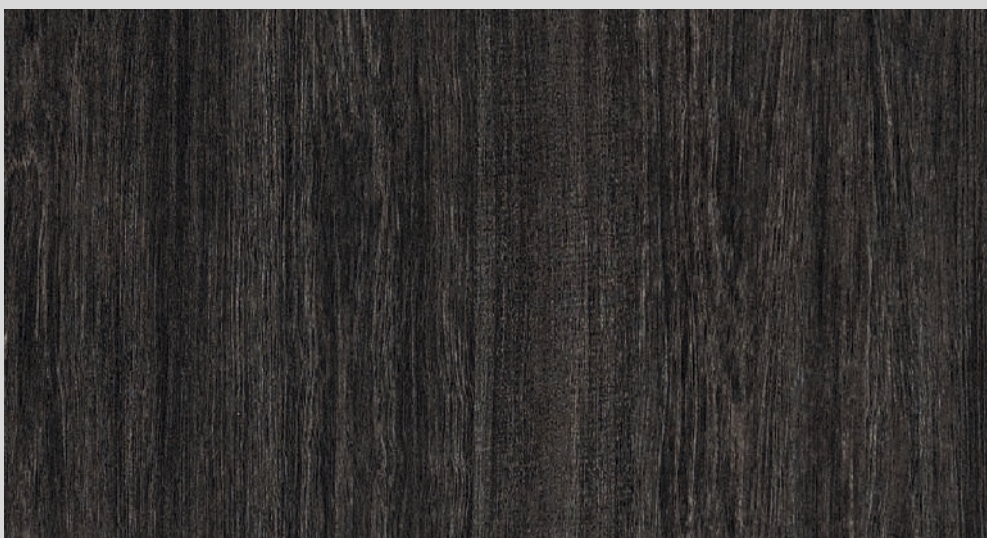

8549 | Addison Times

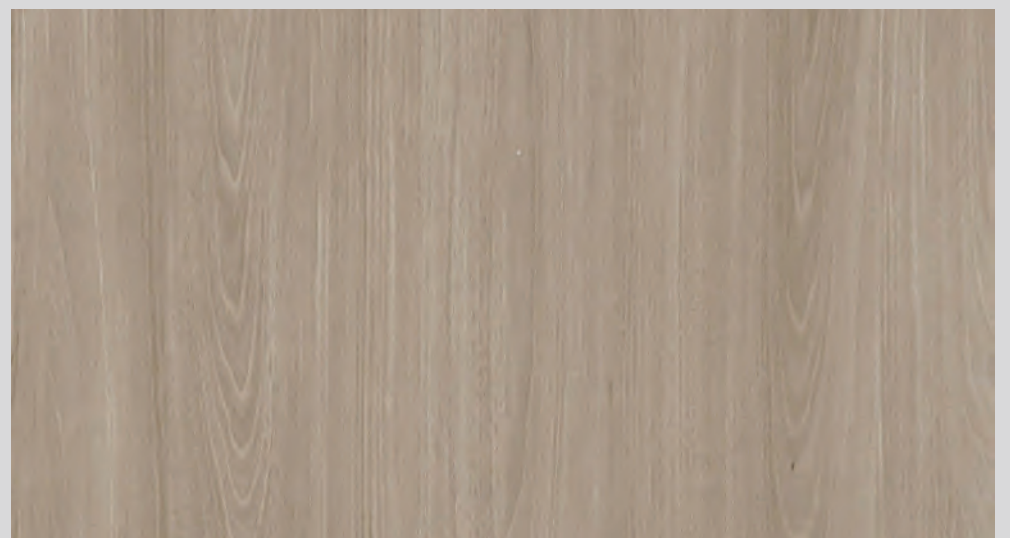

8605 | Pearl Elm





8593 | Regal Cross Wood Light

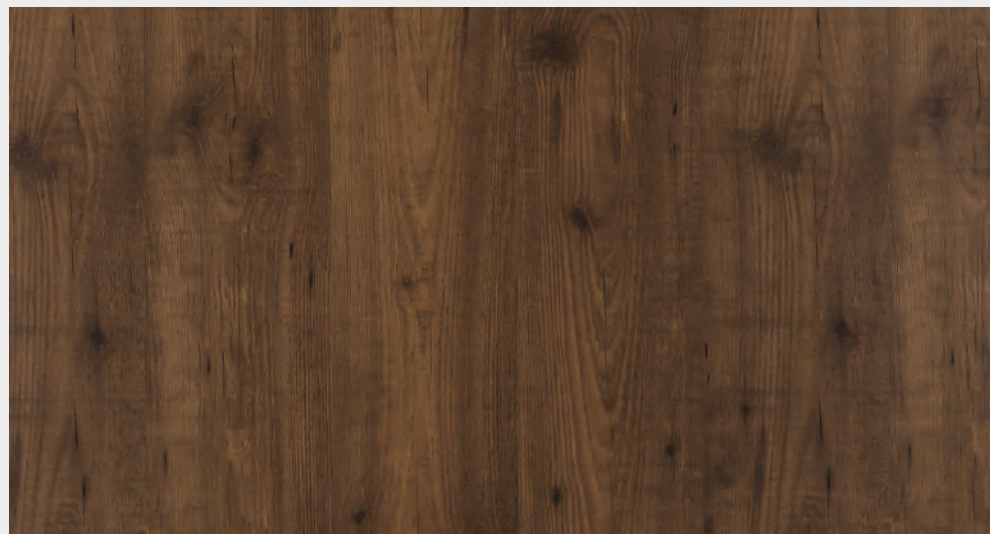

8627 | Novecento Pine



8594 | Regal Cross Wood Dark



8629 | Khaya Mahogany Dark

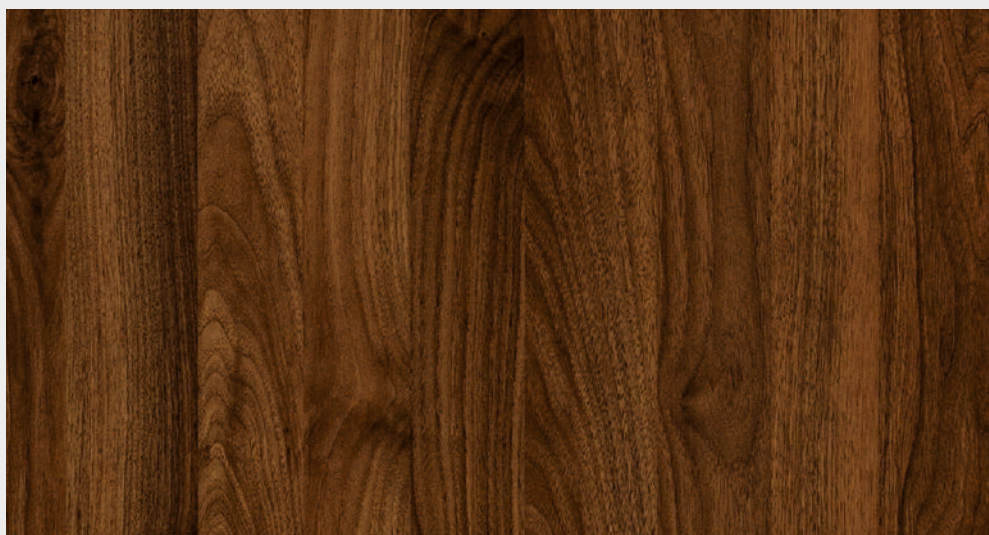

8626 | Columbia Walnut

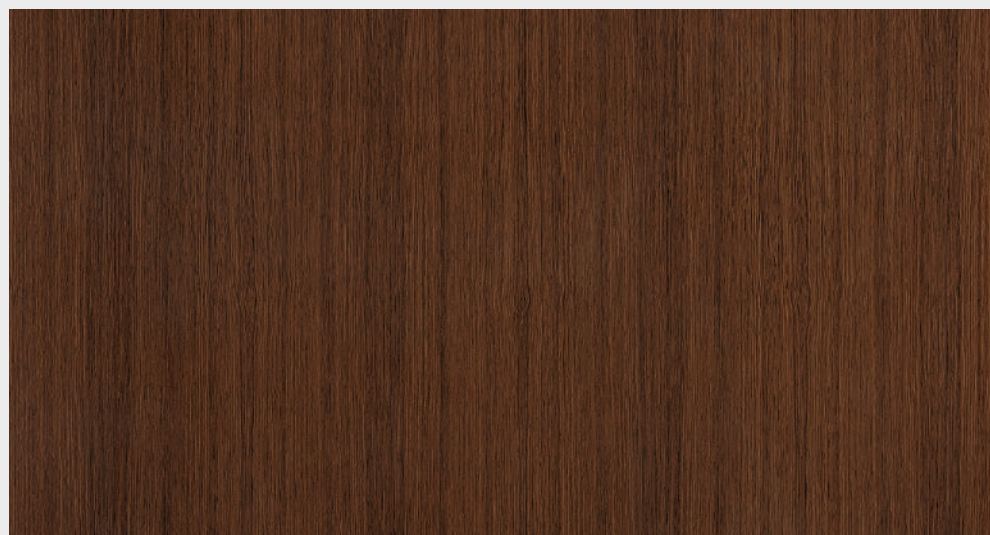

7136 | Queensland Walnut



# WOODGRAINS



8633 | Kitami Light



8634 | Kitami Teak



8635 | Kitami Brown



8636 | Kitami Dark





8637 | Rossini Eiche White



8638 | Rossini Eiche Light



8642 | Kendrick Brown



8639 | Rossini Eiche Brown



8640 | Rossini Eiche Dark



8641 | Kendrick



# WOODGRAINS

---



8652 | Bratty Oak Dark Grey



8665 | Jablon



8666 | Tom Walnut



8667 | Tom Walnut Dark



8671 | Impiana Nyatoh



8672 | Canyon Pekan





8682 | Lumber Teak Dark



8683 | Lumber Teak Brown



8685 | Monastic Light



8689 | Amber Ash Dark



8690 | Continental Walnut



8691 | Delano Oak



# WOODGRAINS

## Heritage in *Grain*



9109 | Sulawesi Dark

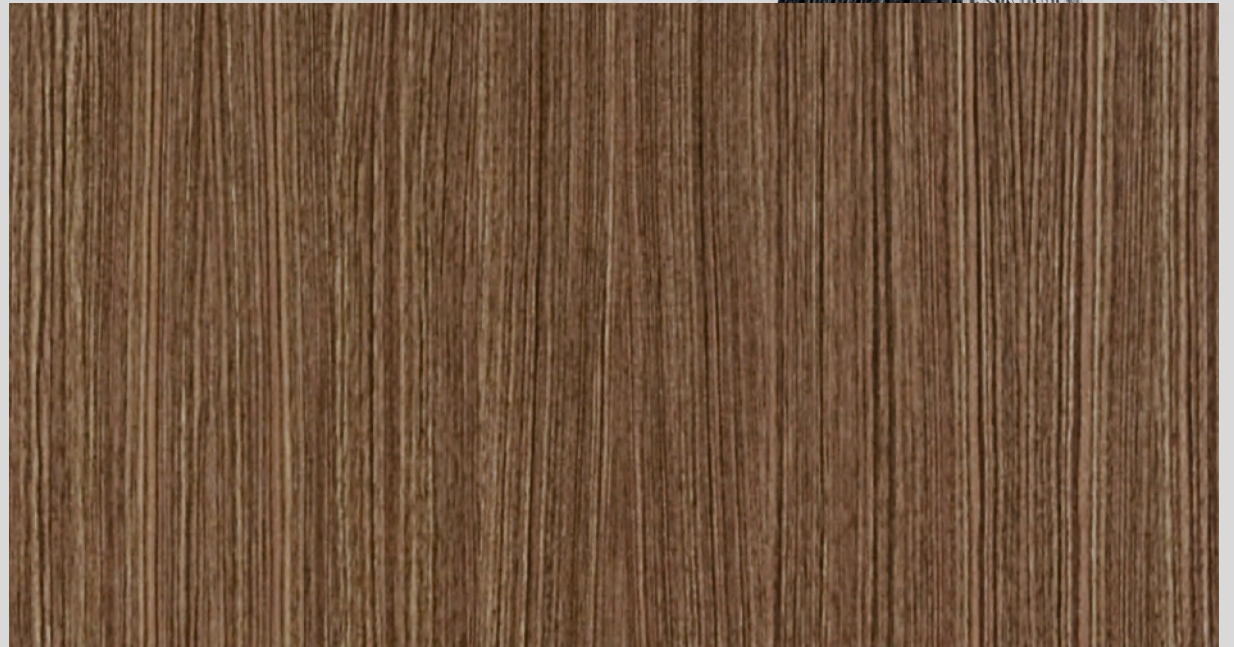

9136 | Tropical Walnut



9137 | Nogalino

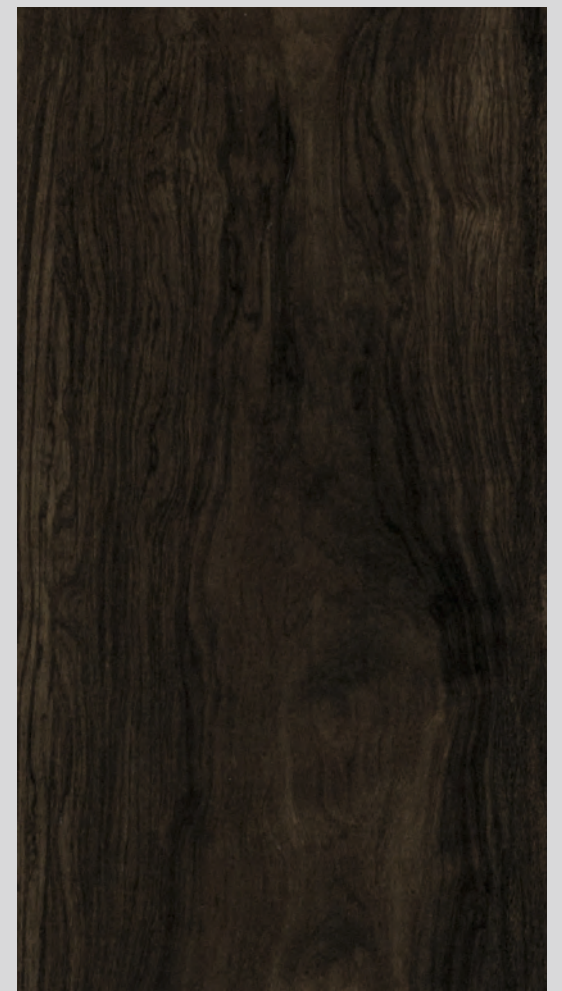

9156 | Sober Dark Walnut





9301 | Tropical Oak



9302 | Celtic Wood

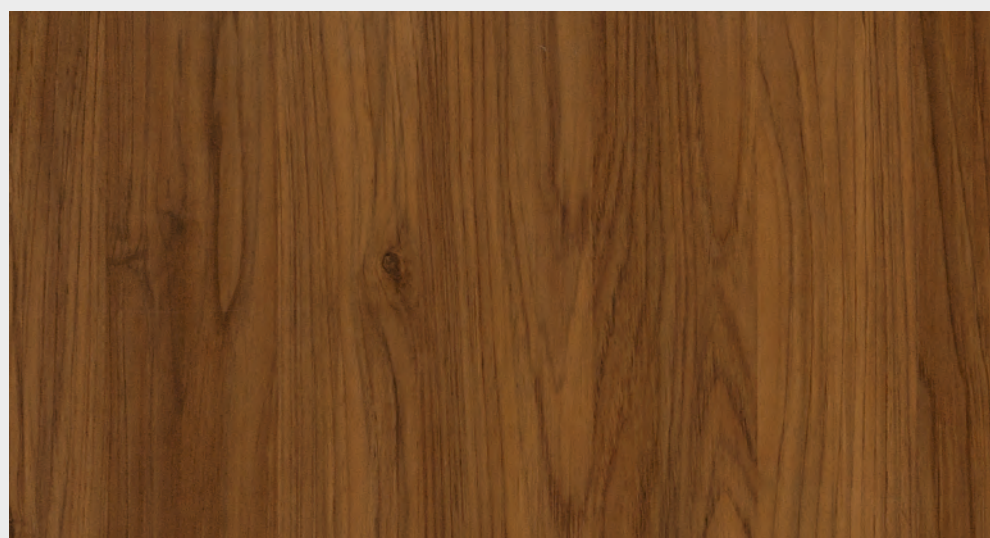

9303 | Twilight Pine

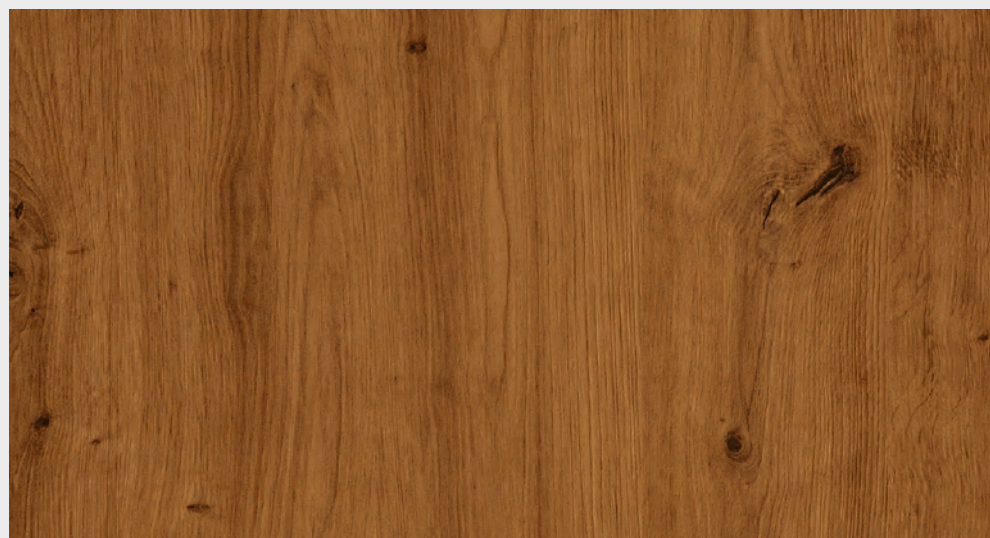

9304 | Columbian Cadiz



# WOODGRAINS

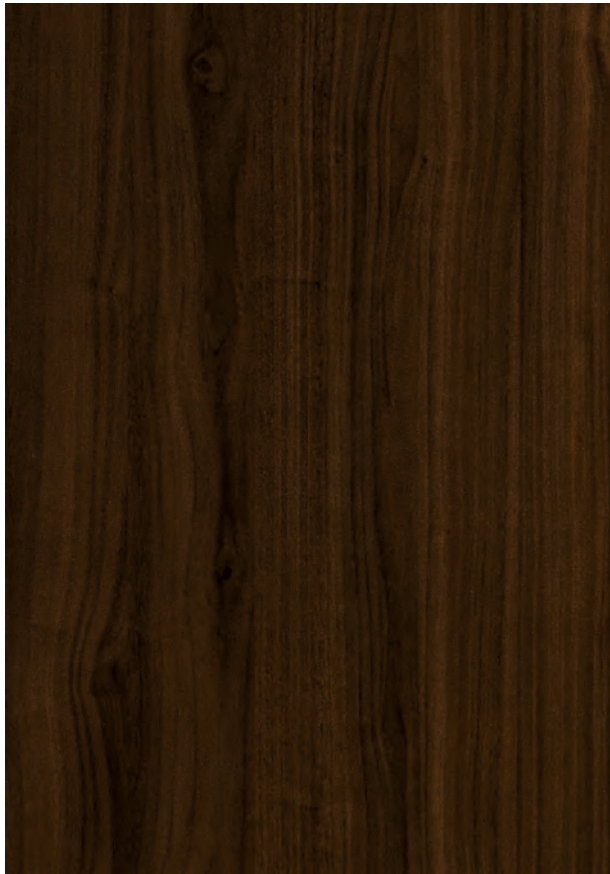
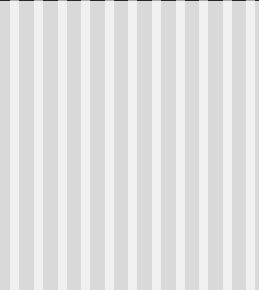

9305 | Desert Pine



9315 | Mushroom Chestnut



9316 | Cream Maple

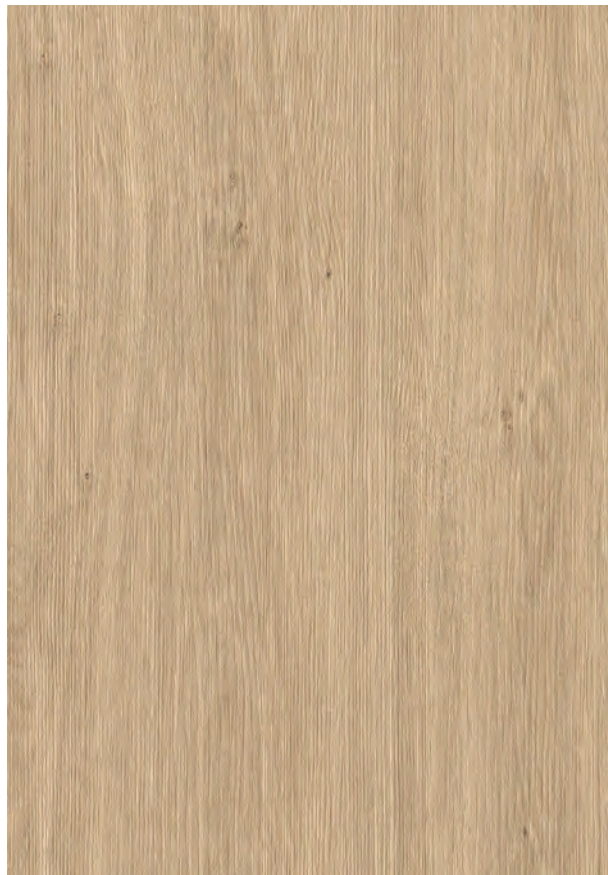

9317 | Birch Plywood

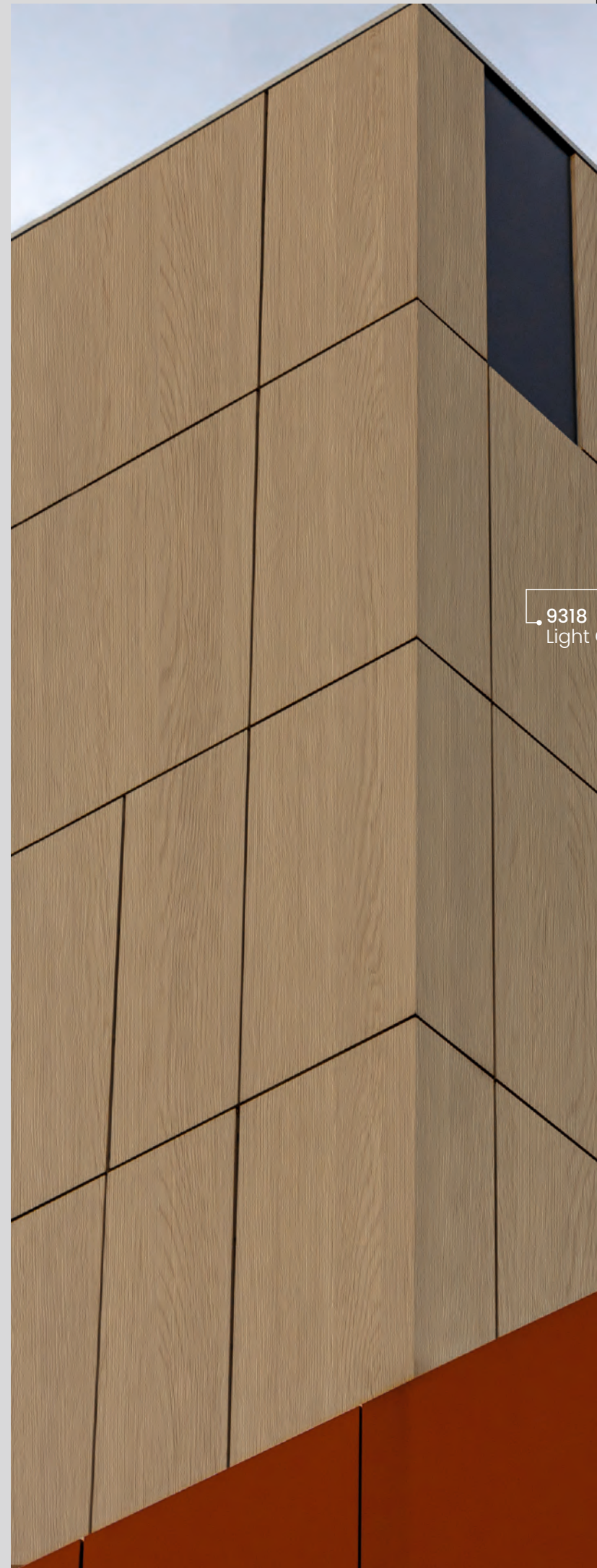

9318  
Light



9318 | Light Cedar



9321 | Vintage Barrel Oak



# WOODGRAINS



9344 | Bianco Venato



9345 | Natural Cedar



9346  
Amber Pine

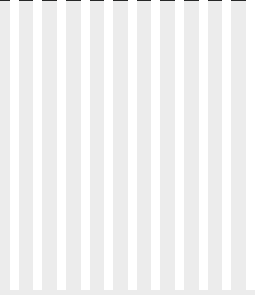

9346 | Amber Pine



9356 | Espresso Oak



9357 | Caramel Teak



# PASTEL & SOLID COLOR

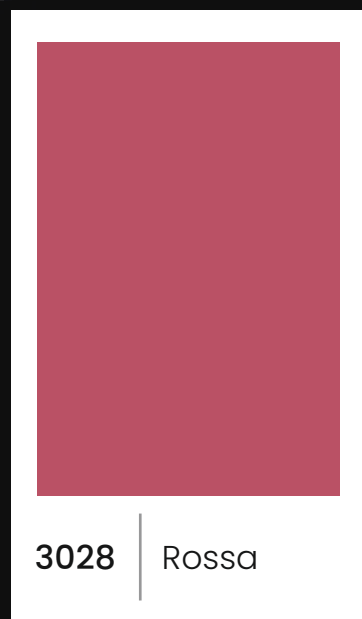
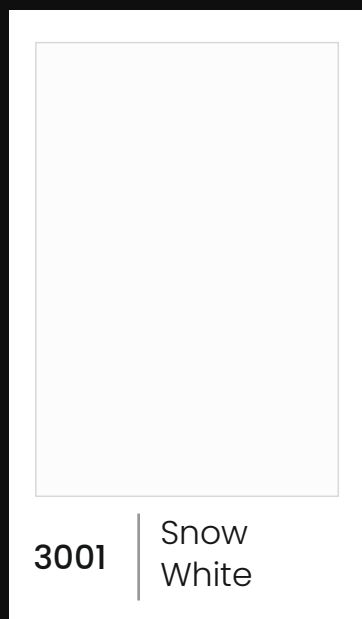
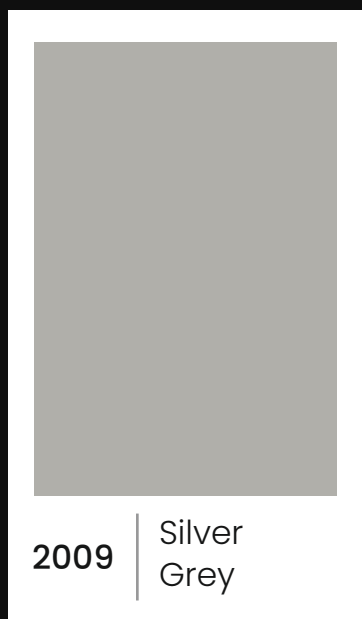
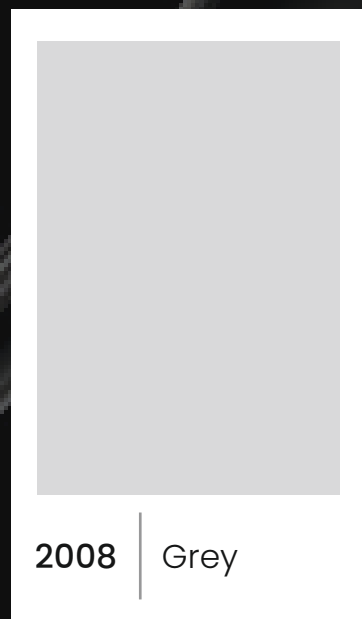
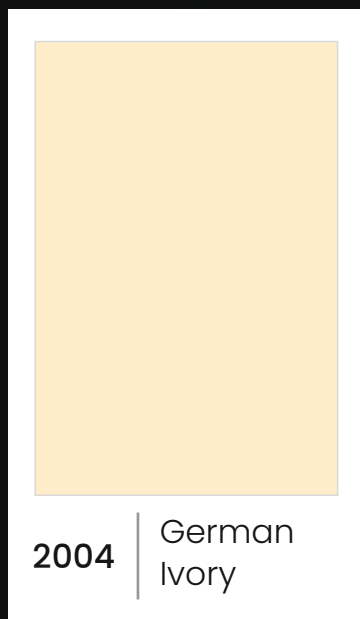
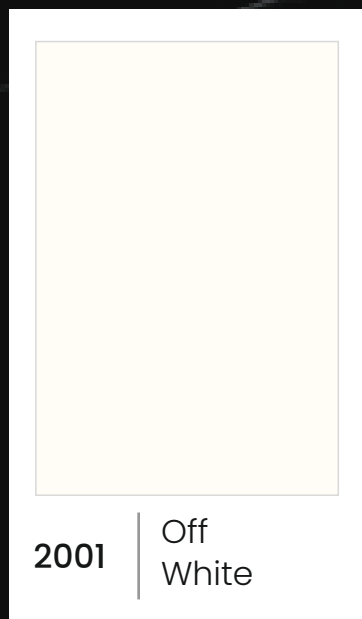
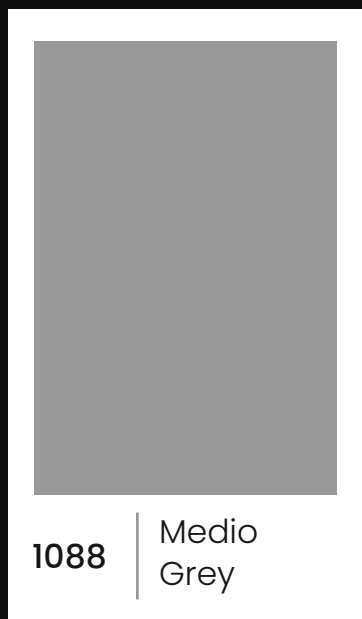
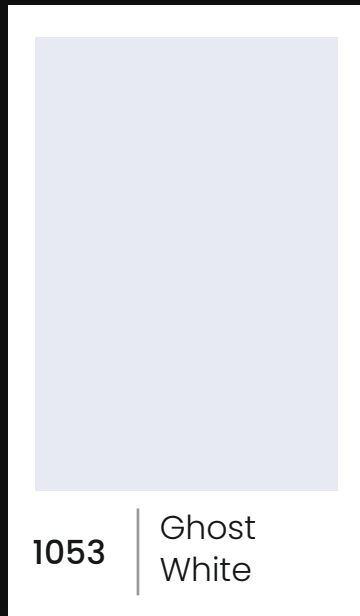
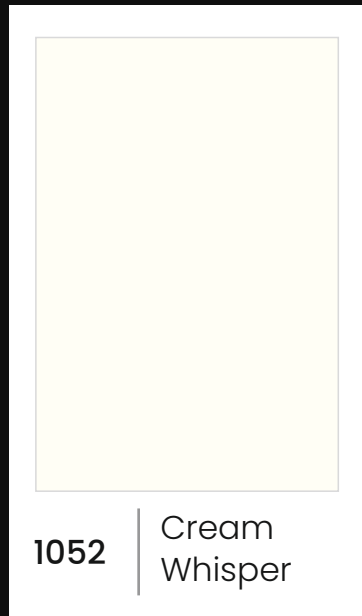
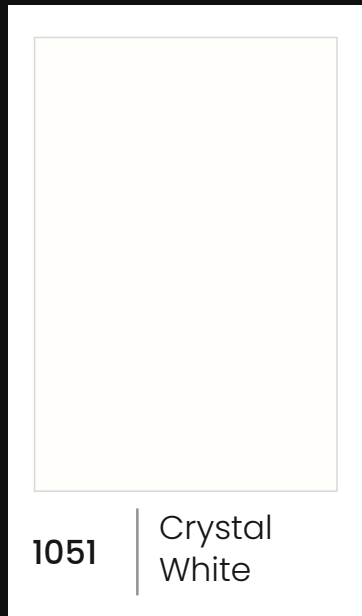

S T Y L E D I N S O L I D S



# Tone with *Power*

  
VIR  
KLADS



3044 | Lilly  
Almond

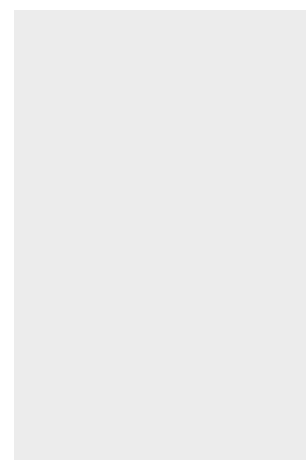

3088 | Mild  
Grey

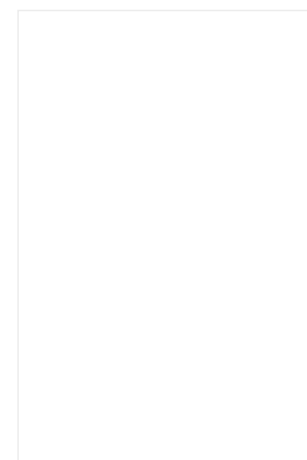

4001 | Milky  
White



4005 | Zurich  
Ivory

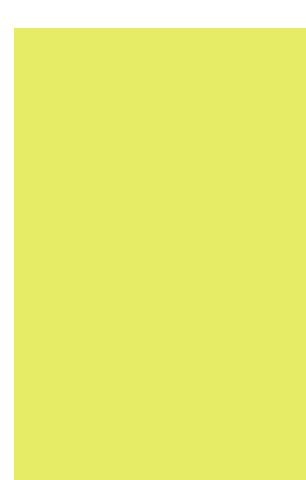

4006 | Buff

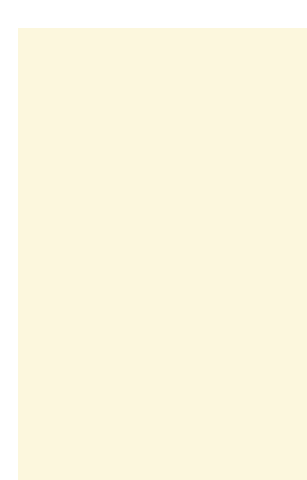

5004 | Mysore  
Ivory



5009 | Gris  
Force



5037 | Orange



5038 | O.b.c.  
Green

# PASTEL & SOLID COLOR

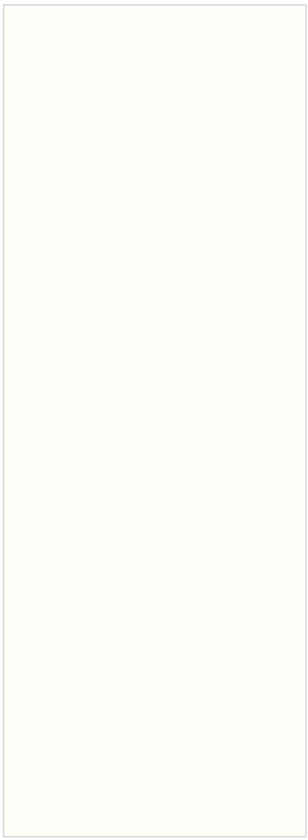

6001 | Frosty White



6034 | Bright Yellow

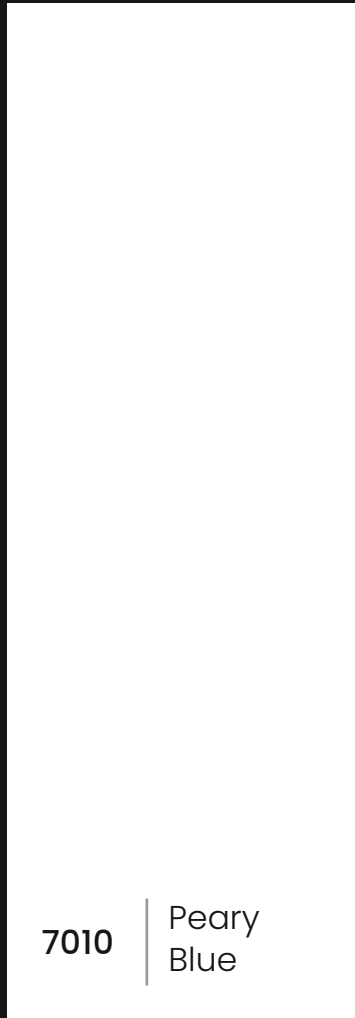

7010 | Peary Blue



7035 | Sweety Pink

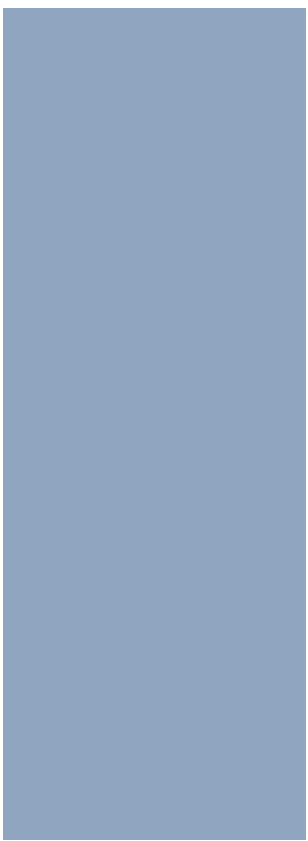

7052 | Elegant Blue-grey



7053 | Graphit Blue

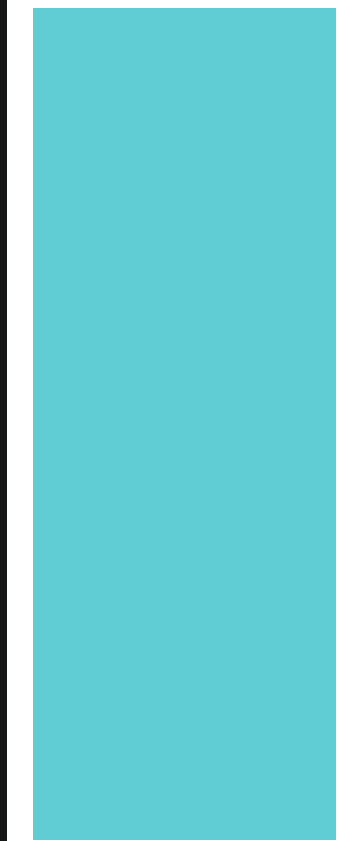

7054 | Seaside Turquoise

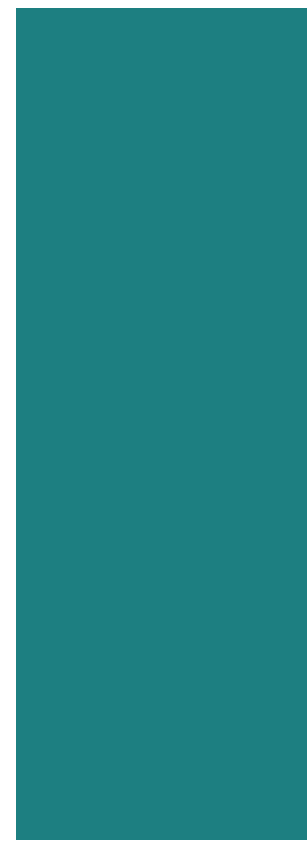

7055 | Deep Turquoise



S T Y L E D I N S O L I D S



7056 | Jungle Green

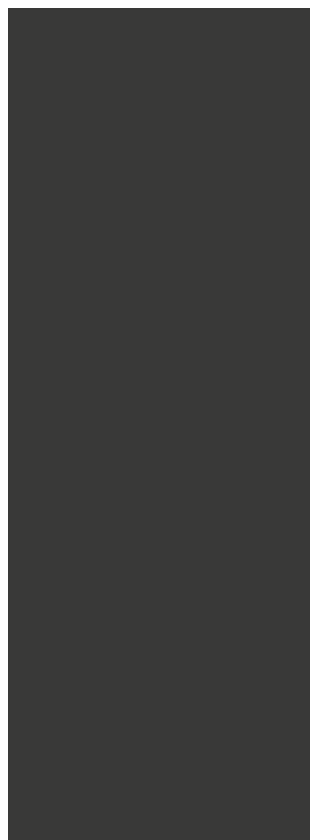

7057 | Carbon Grey

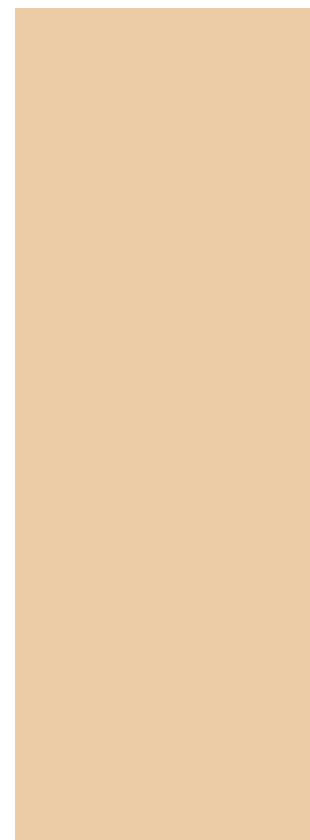

7058 | Creamy Brown



7059 | Calming Brown



7060 | Iron Brown



7061 | Maroon Red



9019 | Cream Clair

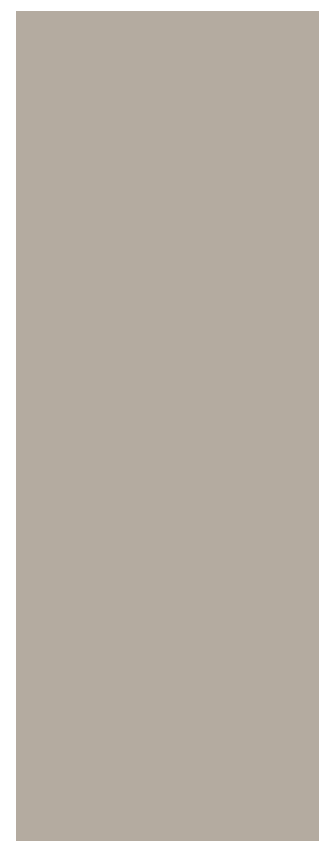

9020 | Wheat

# TECHNICAL SPECIFICATION

## TECHNICAL PROPERTIES VIR EXTERIOR GRADE COMPACT LAMINATE

	PROPERTIES	TEST METHOD AS PER DIN EN 438-2 : 2016	UNIT OF MEASUREMENT	SPECIFIED VALUES AS PER BS EN 438- 6 : 2016	VIR EXTERIOR GRADE COMPACT VALUE
		<b>EN 438-6 : 2016 Classification</b>		<b>EGS / EDS / EGF / EDF</b>	
	<b>Dimensional Tolerances of Panel</b>			<b>Size ( 2440 x 1220 ) mm</b>	
1.1	Thickness	EN 438-2 : 5	mm	5.0 ≤ t < 8.0 mm : max ± 0.4	±0.30
			mm	8.0 ≤ t < 12.0 mm : max ± 0.5	±0.40
			mm	12.0 ≤ t < 16.0 mm : max ± 0.6	±0.50
1.2	Flatness of Panel	EN 438-2 : 9	mm/m	For 2.0 ≤ t < 6.0 mm : max 8.0 mm/m	3.0
			mm/m	For 6.0 ≤ t < 10.0 mm : max 5.0 mm/m	2.0
1.3	Length & Width of Panel	EN 438-2 : 6	mm	+10 mm/-0	+5.0-00
1.4	Straightness of Edges	EN 438-2 : 7	mm/m	1.5 mm/m max deviation	≤ 1.2
1.5	Squareness	EN 438-2 : 8	mm/m	1.5 mm/m max deviation (calculation based on Length of panel)	≤ 1.5
4	Resistance to Impact by Large Diameter Ball (Shatter Resistance)				
4.1	Drop Height	EN 438-2-21	mm	1800 mm (Drop Height)	2200
4.2	Diameter of Indentation		mm	10 (max)	0.3
5	Dimensional Stability at Elevated Temperature	EN 438-2-17			
5.1	a) Longitudinal		%	0.30 (max.)	0.16
5.2	b) Transverse		%	0.60 (max.)	0.32
6	Panel Surface Visibility	EN 438-2 : 4	(Dirt, spots, any similar surface defects).	≤ 2 mm <sup>2</sup> /m <sup>2</sup>	Complies
			Fibre, hair, scratches similar surface defects	≤ 20 mm/m <sup>2</sup>	Complies
<b>MECHANICAL PROPERTIES</b>					<b>VIR EXTERIOR GRADE COMPACT VALUE</b>
7	Flexural Modulus (Stress)	EN ISO 178 : 2003	Mpa	9000(min.)	10500
8	Flexural Strength (Stress)	EN ISO 178 : 2003	Mpa	80(min.)	105
9	Tensile Strength (Stress)	EN ISO 527-2 : 1996	Mpa	60(min.)	70
10	Density	EN ISO 1183-1 : 2004	g/cm <sup>3</sup>	1.35(min.)	1.40 ± 0.05
11	Resistance to wet conditions	EN 438-2 : 15	% max in mass increase	8	0.8
		Surface	Appearance (min)	4	5
		Edge	Appearance (min)	3	5

**LIGHT FASTNESS AND WEATHER RESISTANCE**

	PROPERTIES	TEST METHOD AS PER DIN EN 438-2 : 2016	UNIT	SPECIFIED VALUES AS PER BS EN 438- 6 : 2016	VIR EXTERIOR GRADE COMPACT VALUE
12	Resistance to artificial weathering including light fastness	EN 438-2-29 (Contrast)	Rating	Grey scale Rating not worse than 3 after 650 MJ/M <sup>2</sup> Radiant exposure	>4
		EN 438-2-29 (Appearance)	Rating	Rating minimum 4 after 650 MJ/M <sup>2</sup> Radiant exposure	5
13	Resistance to UV Light	EN 438-2-28 (Contrast)	Rating	Grey scale Rating not worse than 3 after 1500 hours exposure	>4
		EN 438-2-28 (Appearance)	Rating	Rating minimum 4 after 1500 hours exposure	5
14	Resistance to Climatic shock	EN 438-2 : 19	Flexural Strength Index (min)	0.8	0.98
		EN 438-2 : 19	Flexural Modulus Index (min)	0.8	0.95
		EN 438-2 : 19	Rating(min)	4	5
15	Thermal Conductivity	EN 12664-2001	W/m.k	0.3	0.31
16	Durability Test, Resistance to Immersion In Boiling Water	EN 438-7-2005			
a	Mass Increase %	EN 438-7-2005	% Max	2	0.34
b	Thickness Increase %	EN 438-2 : 2016	% Max	2	0.21
c	Surface Rating Scale	EN 438-2 : 2016	Min	4	5

**FIRE PERFORMANCE PROPERTIES**

	PROPERTIES		UNIT	SPECIFIED VALUES AS PER BSEN 438-6 : 2016	VIR EXTERIOR GRADE COMPACT VALUE
1	Reaction to fire	Classification standards EN 13501-1 : 2007 Tested according to EN 13823:2010 & EN 11925-2 :2010	Euro Class	Classification t ≥ 6mm	B, S1, d0
2	Flammability Test	UL-94:1997 Classification Requirements	Class	V-0	V-0
3	Spread of flame.	Classification as per BS 476-7	Class	Class-1	Class-1
4	Fire Propagation Test	As per BS 476-6	I (Index)	Test Results based upon Product Behaviour (Test Report No : 7191166866- MEC17/5-YWA)	19.1
5	Reaction to fire ( Germany)	DIN 4102-1	Class	B1	NA
6	Reaction to fire ( France )	NF P 92-501	Class	M1	NA

# INDEX

S. NO.	D. NO.	NAME	P. NO.
01	117	Bunty Oak	18
02	401	Burma Teak	18
03	1051	Crystal White	43
04	1052	Cream Whisper	43
05	1053	Ghost White	43
06	1054	Blackout	43
07	1088	Medio Grey	43
08	1121	High Land Pine	19
09	1130	Bavarian Beech	19
10	1171	Ice Pear	19
11	1175	Nice Wood	20
12	1176	American Maple	21
13	1200	Teak Cantabria	21
14	1400	Walnut Tiepolo	21
15	2001	Off White	43
16	2004	German Ivory	43
17	2008	Grey	43
18	2009	Silver Grey	43
19	2129	Madras Teak	21
20	2164	Malasian Cherry	22
21	2174	Vancouver Ahora	22
22	2221	Mild Beech	22
23	3001	Snow White	43
24	3027	Dusty Red	43
25	3028	Rossa	43
26	3044	Lilly Almond	44
27	3088	Mild Grey	44
28	3100	Paris Brown	14
29	3152	Moldau Acacia	23
30	3200	Paris Grey	14
31	3311	Lynar Maple	23
32	4001	Milky White	44
33	4005	Zurich Ivory	44
34	4006	Buff	44
35	4136	Wenge Teak	03
36	4152	Covientry Akazie	04
37	4164	American Cherry	04
38	4602	Greystone	05
39	5004	Mysore Ivory	44
40	5009	Gris Force	44
41	5037	Orange	44
42	5038	O.B.C. Green	44
43	5137	Walnut Classic	24
44	5180	European White Elm	24
45	6001	Frosty White	45
46	6034	Bright Yellow	45
47	6101	Light Nordic	21
48	6102	Cherry Nordic	26
49	6129	Sea Beech	21
50	6146	Noce Soleri	26
51	7010	Peary Blue	45
52	7035	Sweety Pink	45

S. NO.	D. NO.	NAME	P. NO.
53	7052	Elegant Blue-Grey	45
54	7053	Graphit Blue	45
55	7054	Seaside Turquoise	45
56	7055	Deep Turquoise	45
57	7056	Jungle Green	46
58	7057	Carbon Grey	46
59	7058	Creamy Brown	46
60	7059	Calming Brown	46
61	7060	Iron Brown	46
62	7061	Maroon Red	46
63	7136	Queensland Walnut	32
64	7171	Nice Pear Wood	23
65	8113	Rushil Teak	22
66	8116	Luminosity Walnut	22
67	8117	Mysterious Walnut	25
68	8118	Rigato Walnut	25
69	8129	Princess Beech	25
70	8136	Kampla Wenge	26
71	8140	Japan Beech	26
72	8145	Storm Wood	26
73	8146	Vintage Wood	27
74	8147	Country Pear	28
75	8149	City Pear	28
76	8151	White Rushil Wood	28
77	8162	Smoked Oak	28
78	8163	Chalked Oak	29
79	8179	Thames Oak	29
80	8189	Prima Oak	29
81	8515	Choco Planked Walnut	29
82	8516	Atlas Planked Walnut	29
83	8523	Dark Eminence	29
84	8526	Light Arctic Birch	30
85	8527	Dark Arctic Birch	30
86	8528	Angola Walnut Light	30
87	8529	Angola Walnut Brown	30
88	8530	Angola Walnut Dark	30
89	8534	Merapi Walnut	30
90	8536	Canyon Wood Light	31
91	8537	Canyon Wood Dark	31
92	8549	Addison Times	31
93	8569	Kamala	06
94	8582	Bonito	06
95	8585	Vintage Pine Light	31
96	8586	Vintage Pine Dark	31
97	8593	Regal Cross Wood Light	32
98	8594	Regal Cross Wood Dark	32
99	8605	Pearl Elm	31
100	8623	Misty Bronze	12
101	8624	Twist Dark Grey	12
102	8626	Columbia Walnut	32
103	8627	Novecento Pine	32
104	8629	Khaya Mahogany Dark	32

S. NO.	D. NO.	NAME	P. NO.
105	8633	Kitami Light	33
106	8634	Kitami Teak	33
107	8635	Kitami Teak	33
108	8636	Kitami Dark	33
109	8637	Rossini Eiche White	34
110	8638	Rossini Eiche Light	34
111	8639	Rossini Eiche Brown	34
112	8640	Rossini Eiche Dark	34
113	8641	Kendrick	34
114	8642	Kendrick Brown	34
115	8643	Odin Eiche Light	19
116	8644	Odin Eiche Dark	19
117	8651	Bratty Oak Grey	19
118	8652	Bratty Oak Dark Grey	35
119	8653	Perito	08
120	8654	Zebra Mable	07
121	8656	Sinope Marble	08
122	8663	Venice	10
123	8665	Jablon	35
124	8666	Tom Walnut	35
125	8667	Tom Walnut Dark	35
126	8671	Impiana Nyatoh	35
127	8672	Canyon Pekan	35
128	8677	Greta Light	02
129	8678	Greta Dark	02
130	8682	Lumber Teak Dark	36
131	8683	Lumber Teak Brown	36
132	8685	Monastic Light	36
133	8689	Amber Ash Dark	36
134	8690	Continental Walnut	36
135	8691	Delano Oak	36
136	8692	Teak Indonesia	24
137	8693	Pasture Walnut	24
138	8694	Brentwood Oak	18
139	8696	Ardent Oak Dark	18
140	8697	Travertin Light	09
141	8698	Travertin Dark	09
142	8801	White Glitter	11
143	8802	Burgeon Glitter	11
144	8803	Brown Glitter	11
145	8804	Titanio Glitter	11
146	8805	Dark Grey Glitter	11
147	9019	Cream Clair	46
148	9020	Wheat	46
149	9106	Savall Mahogany	18
150	9107	Arkan Wood	18
151	9109	Sulawesi Dark	37
152	9136	Tropical Walnut	37
153	9137	Nogalino	37
154	9156	Sober Dark Walnut	37
155	9301	Tropical Oak	38
156	9302	Celtic Wood	38

# INDEX

S. NO.	D. NO.	NAME	P. NO.
157	9303	Twilight Pine	38
158	9304	Columbian Cadiz	38
159	9305	Desert Pine	39
160	9306	Coral Stone	15
161	9315	Mushroom Chestnut	39
162	9316	Cream Maple	39
163	9317	Birch Plywood	39
164	9318	Light Cedar	40
165	9321	Vintage Barrel Oak	40
166	9322	Calacatta Elegance	14
167	9323	Arabescato	14
168	9324	Tuscany Grey	14
169	9325	Midnight Marquina	14
170	9326	Midnight Onyx	15
171	9327	Grigio Carnico	15
172	9328	Graphite Grey	16
173	9329	Charcoal Marble	16
174	9330	Pietra Grey	16
175	9331	Khaki Carrara	17
176	9332	Stormy Stone	17
177	9341	Rustic Chevron	02
178	9342	Woodland Zigzag	01
179	9343	Brown Wave	02
180	9344	Bianco Venato	41
181	9345	Natural Cedar	41
182	9346	Amber Pine	42
183	9356	Espresso Oak	42
184	9357	Caramel Teak	42
185	12508	Travertino Grigio Light	13
186	12509	Travertino Grigio Dark	13
187	12510	Green Alta Gris	13

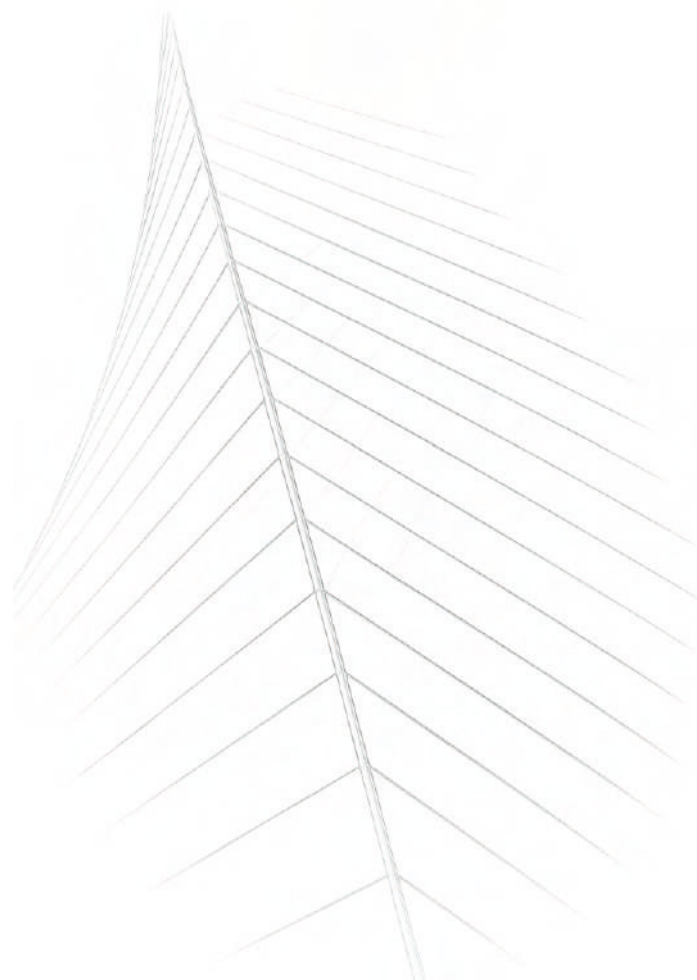

# KLADS

Architectural  
*Elegance*

“Klads redefines the essence of exterior living by blending the timeless beauty of natural textures with the enduring strength of modern innovation, creating facades that stand as masterpieces of architecture.”



**Corporate Office:**

Rushil Décor Ltd., Rushil House, Near Neelkanth Green Bungalow, Off Sindhu Bhavan Road, Shilaj, Ahmedabad-380059, Gujarat, India.

**Contact Us:**

Ph. No.: +91-79-61400400 | [info@rushil.com](mailto:info@rushil.com) | [www.virlaminate.com](http://www.virlaminate.com)  
Toll-Free No.: 1800 233 7952

**Certifications :**



Certification Number : 042-016-1266  
"Environmentally Improved Low Emission Low Toxicity"



ISO 9001 : 2015  
ISO 14001 : 2015  
ISO 45001 : 2018



0026

